

Straightener feeder assembly explosion view

Number of pages

13 pages, page 2

prepared by

Review

approve

name

Final assembly

Version

A

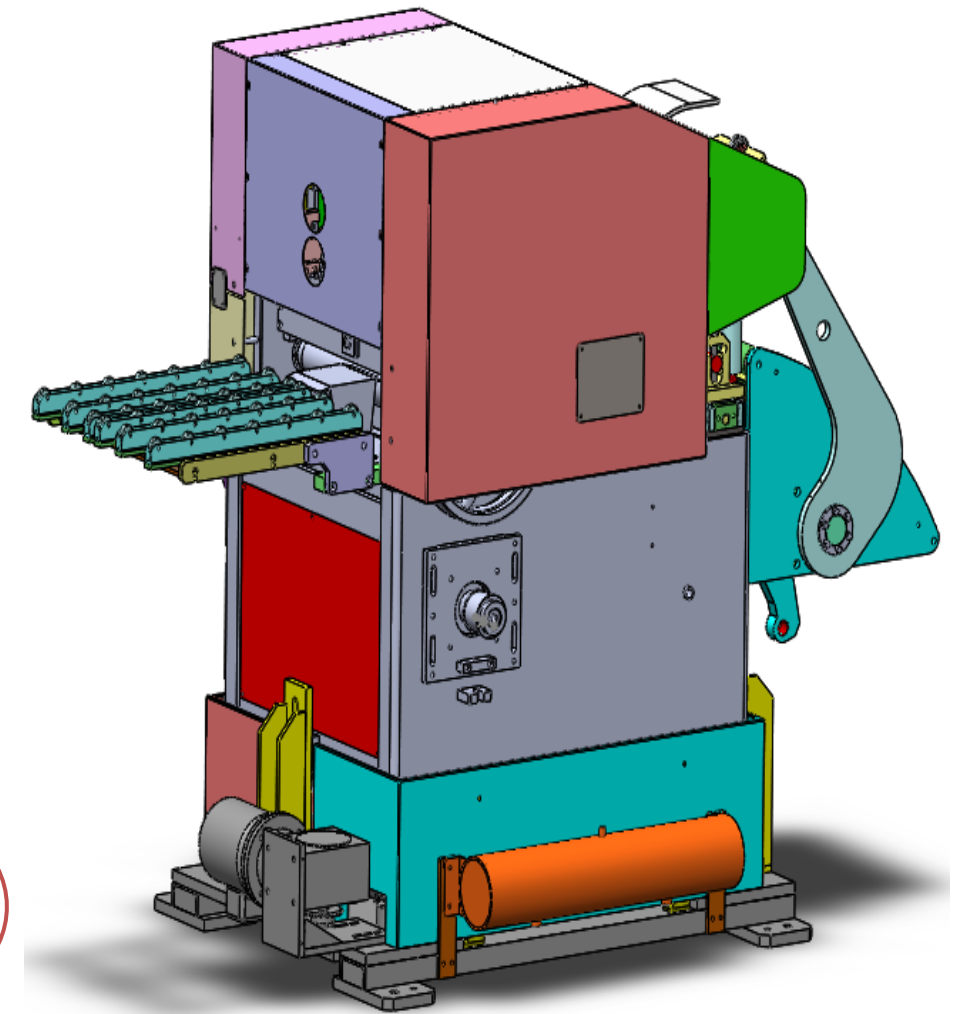
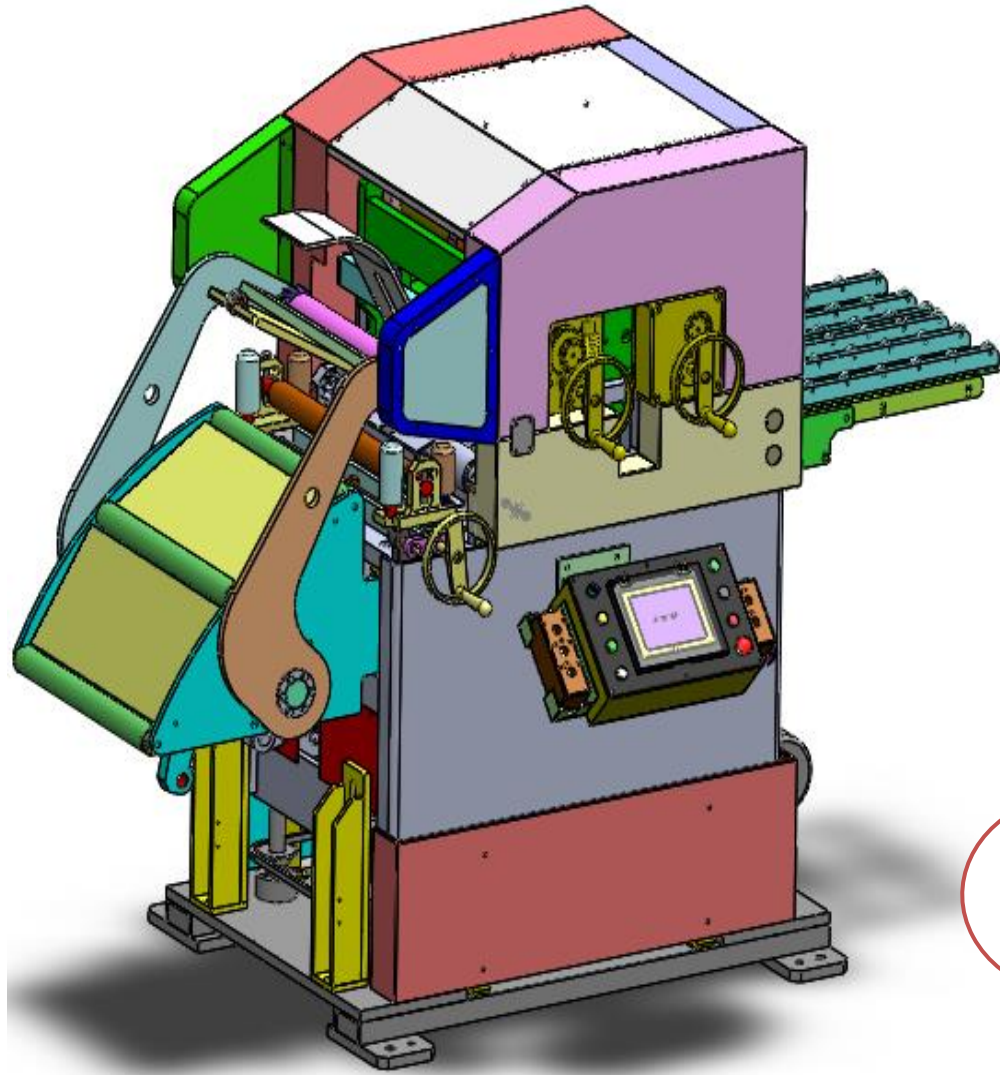

Header shell part

inlet plate

Straightener head

Coil keeper roller

Outlet guide component

Feed guide part

Frame body

Operating box part

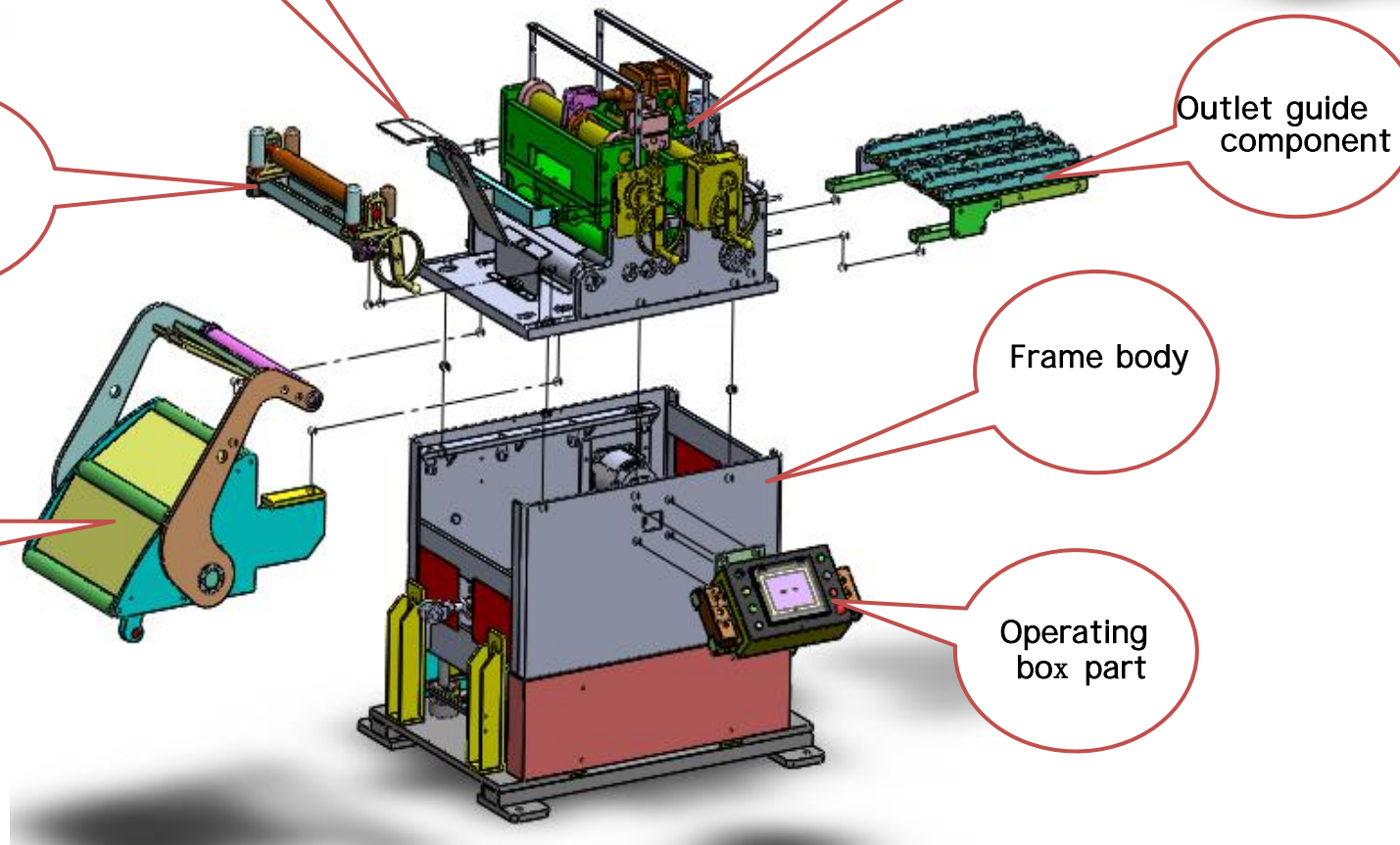

Straightener feeder assembly explosion view

Number of pages	13 pages 1 page 1	prepared by	Review
name	Straightener feeder head of the machine		approve Version
			A

Final assembly

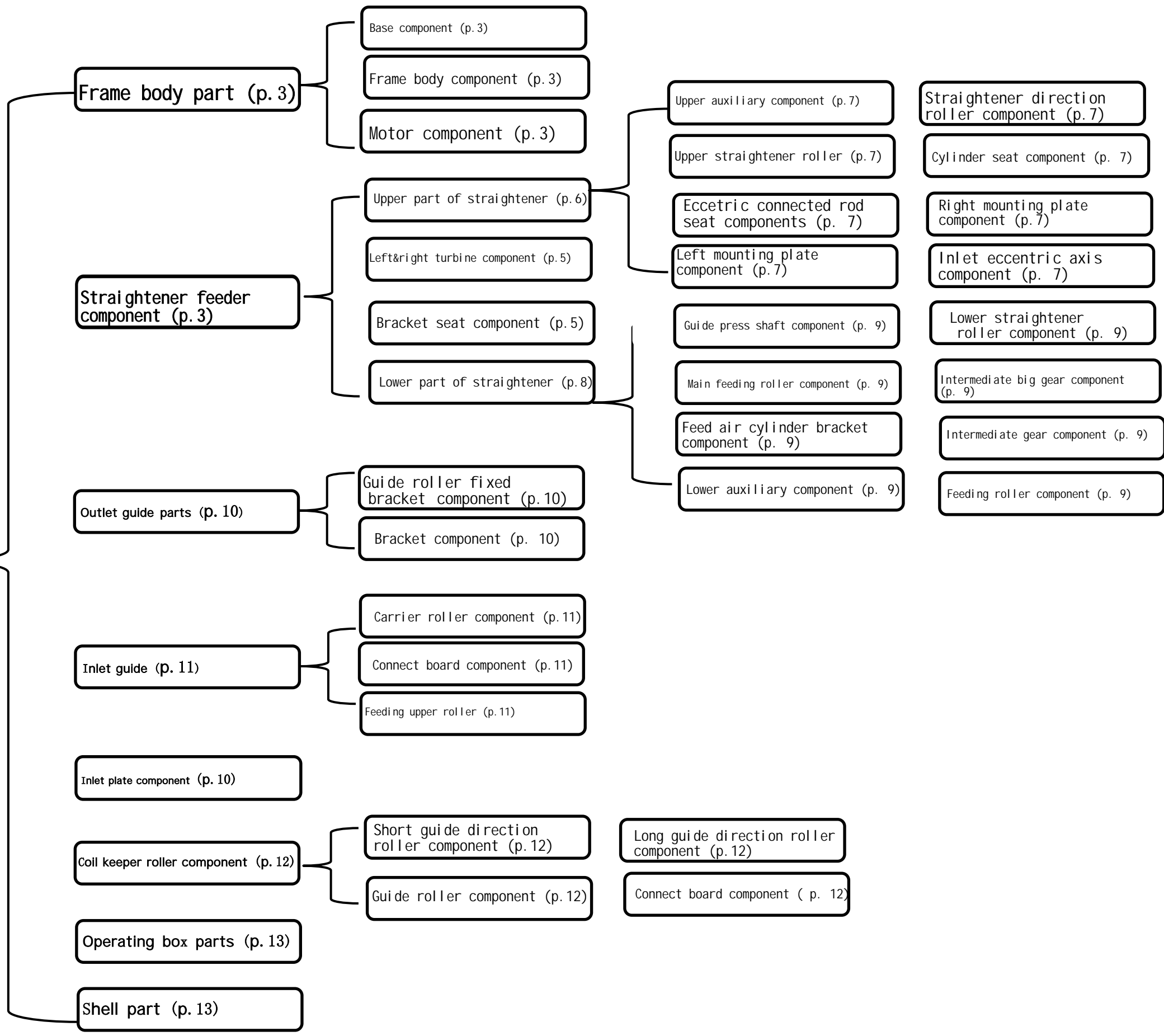

Straightener upper part assembly explosion view

Number of pages	13 pages, page 3	prepared by	Review	approve	
name	Component of frame body (1. Base component, 2. Frame body component)		Version	A	

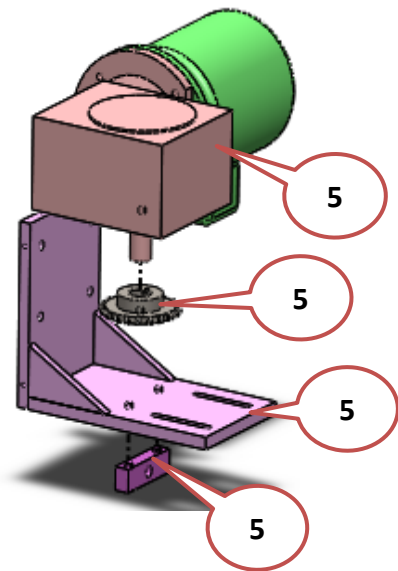

Motor component

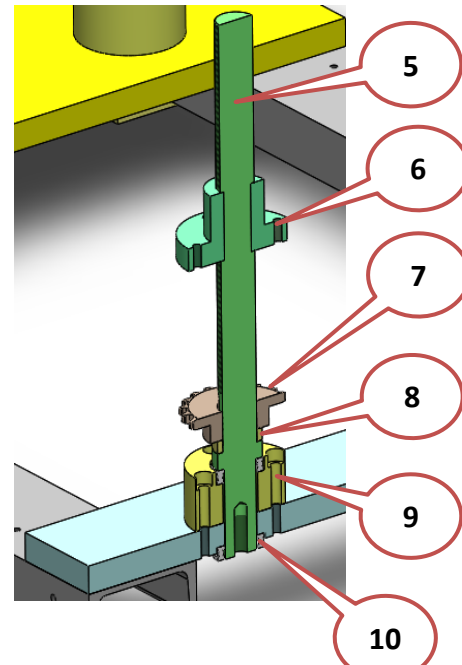

Section magnification Figure A

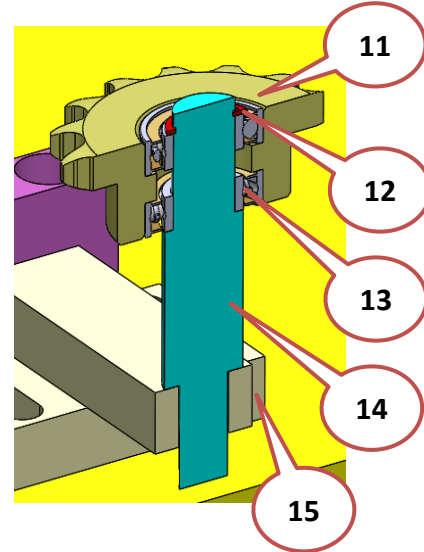

Section magnifying Figure B

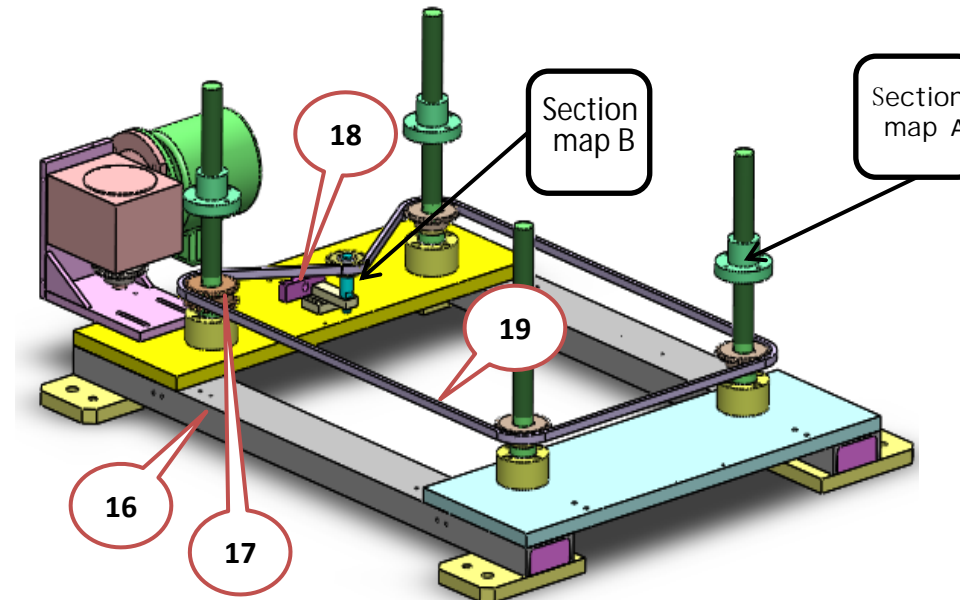

Base component

Straightener feeder rack component

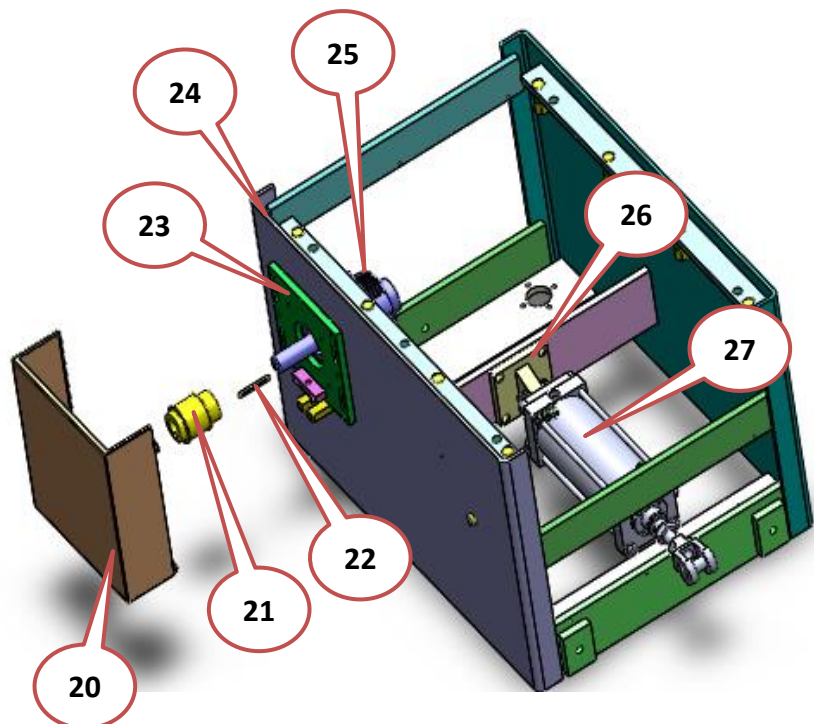

Straightener feeder head part

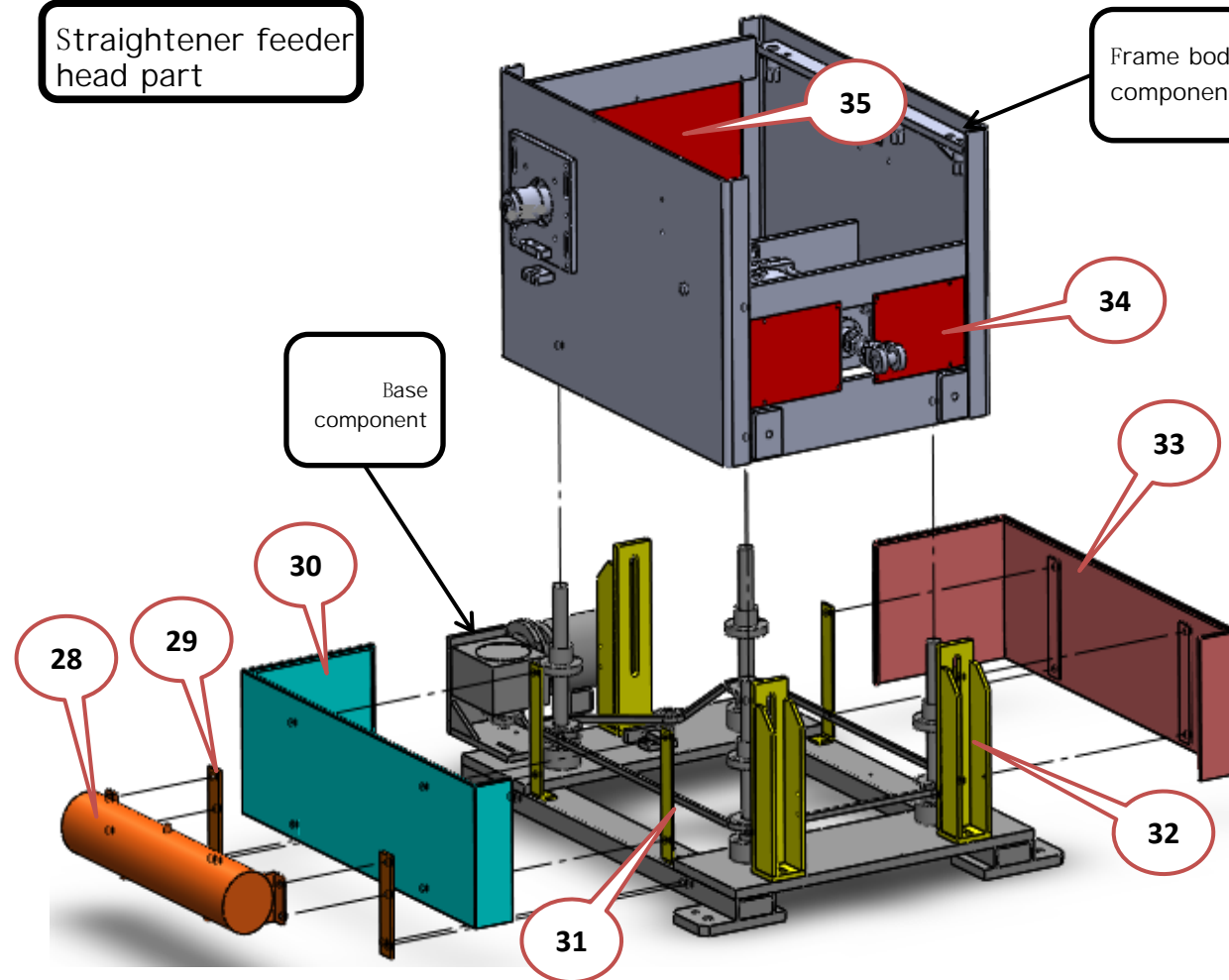

Serial number	Frame body/number/name
1	Motor 0.75kW, Aluminum alloy worm reducer 1HP 60 ratio Model 70
2	023-00-21010 Reducer sprocket
3	023-00-21009 Motor fixed seat (2)
4	023-00-21002-10 Motor tight board
5	023-00-21004 Screw <4>
6	023-00-21006 Lift nut <4>
7	023-00-21007 Lift link wheel (1) <4>
8	023-00-21019 Sprocket cushion circle <4>
9	023-00-21005 Positioning set <4>
10	Thrust ball bearings 51107 <5>
11	023-00-21011 Tight chain wheel
12	GB894. 2-86 Elastic block B type B type B 20
13	Deep groove ball bearings 6904-2Z
14	023-00-21013 Tight shaft
15	023-00-21012 Tight
16	023-06-21001 Header
17	023-00-21008 Link splin wheel (2)
18	023-00-21002-10 Motor tight board
19	Chain
20	023-00-52012 Rear cover
21	003-00-21015 Motor band
22	GB / T1096-1979 Ordinary flat key A 10 × 90
23	023-00-21002-09 Servo motor plate
24	NR-WI-023-06-21002-A0 Straightener shelf
25	SGMGV-55ADC61
26	SCS2-140-B1
27	SCS-LN-CB-140B-300-R0-D-YB1
28	023-00-21014-A1 Gas tank
29	023-00-21021-A1 Gas storage tank support board
30	023-06-21001-03-A1 Backhill
31	023-00-21001-04-A1 Fixed seat of the front plate
32	023-00-21003 L-square plate
33	023-06-21001-02-A1 Front Plate
34	023-06-52001 Front seal plate
35	023-06-52002 Rear seal plate

Straightener upper part assembly explosion view

Number of pages	13 pages, page 5	prepared by	Review
name	1. Left, right snail box component, 2. supporting component		approve Version
			A

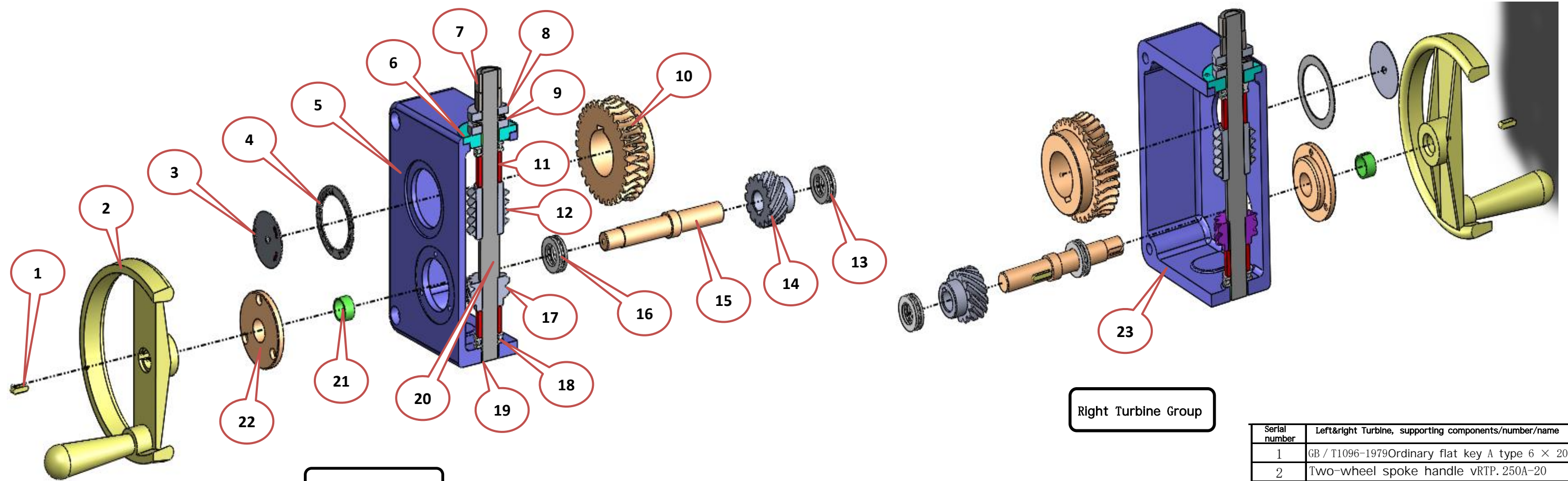

Left Turbine Group

Right Turbine Group

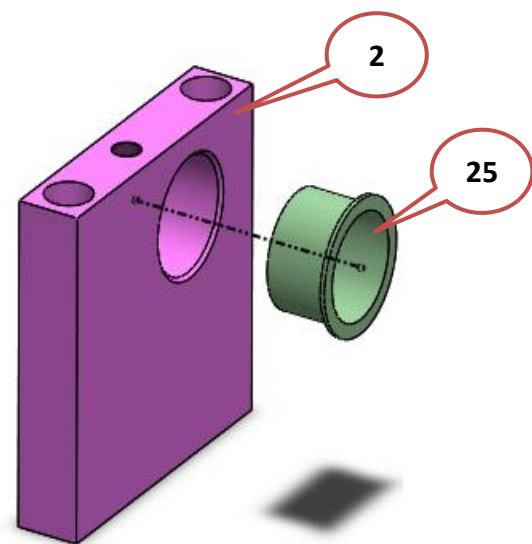

Right rear support group

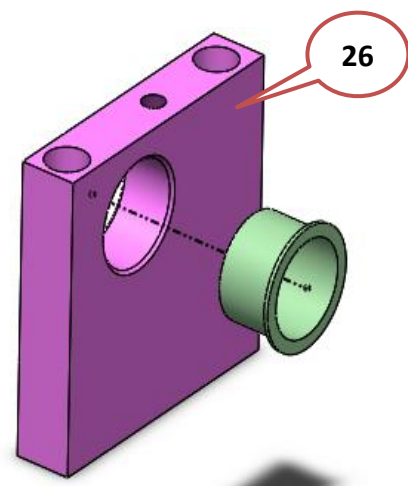

Right front support group

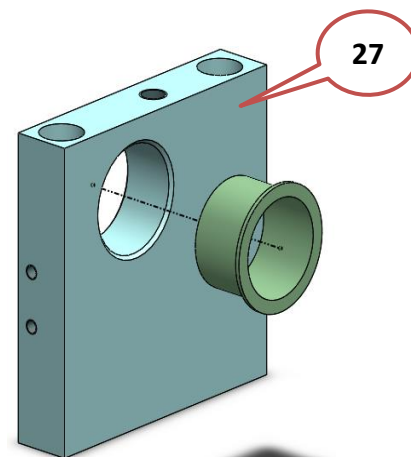

Right rear support group

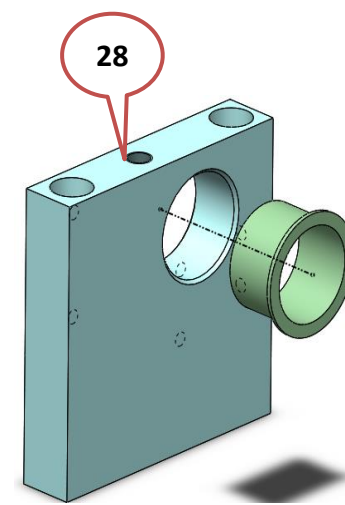

Right front support group

Serial number	Left&right Turbine, supporting components/number/name
1	GB / T1096-1979 Ordinary flat key A type 6 × 20
2	Two-wheel spoke handle vRTP. 250A-20
3	003-00-27005-1 Signing signs on the left
4	003-00-27004-1 Betal fixed signs on the left
5	003-00-27006-1 Left Turbine
6	023-00-27009 French disk A
7	Type 1 hexagonal nut C -Class M20
8	023-00-27003 washer
9	40-2.75 Dish spring
10	003-00-27012 Turbine 30×3
11	003-00-27014 Turbine cushion circle 1
12	023-00-27011 Turbine rod 1 × 30
13	Thrust ball bearings 51104
14	023-00-27001-2 Right rotten diagonal gear 1
15	023-00-27008 Manipulating axle
16	Thrust ball bearings 51104
17	023-00-27002-2 Right -rotation diagonal gear 2
18	Thrust ball bearings 51104
19	SF-1X Bearing (202312)
20	003-00-27013 Turbine transmission shaft
21	SF-1X Bearing (202312)
22	023-00-27010 French disk B
23	003-00-27006-2 Right Turbine
24	003-00-24025-02 Right back support
25	FB090 (70X60X55X35)
26	003-00-24025-01 Right front support
27	003-00-24016-02 Left back support
28	003-00-24016-01 Left front support
29	
30	
31	

Straightener upper part assembly explosion view

Number of pages	13 pages, page 4	prepared by	Review
name	Straightener head part component		approve Version
			A

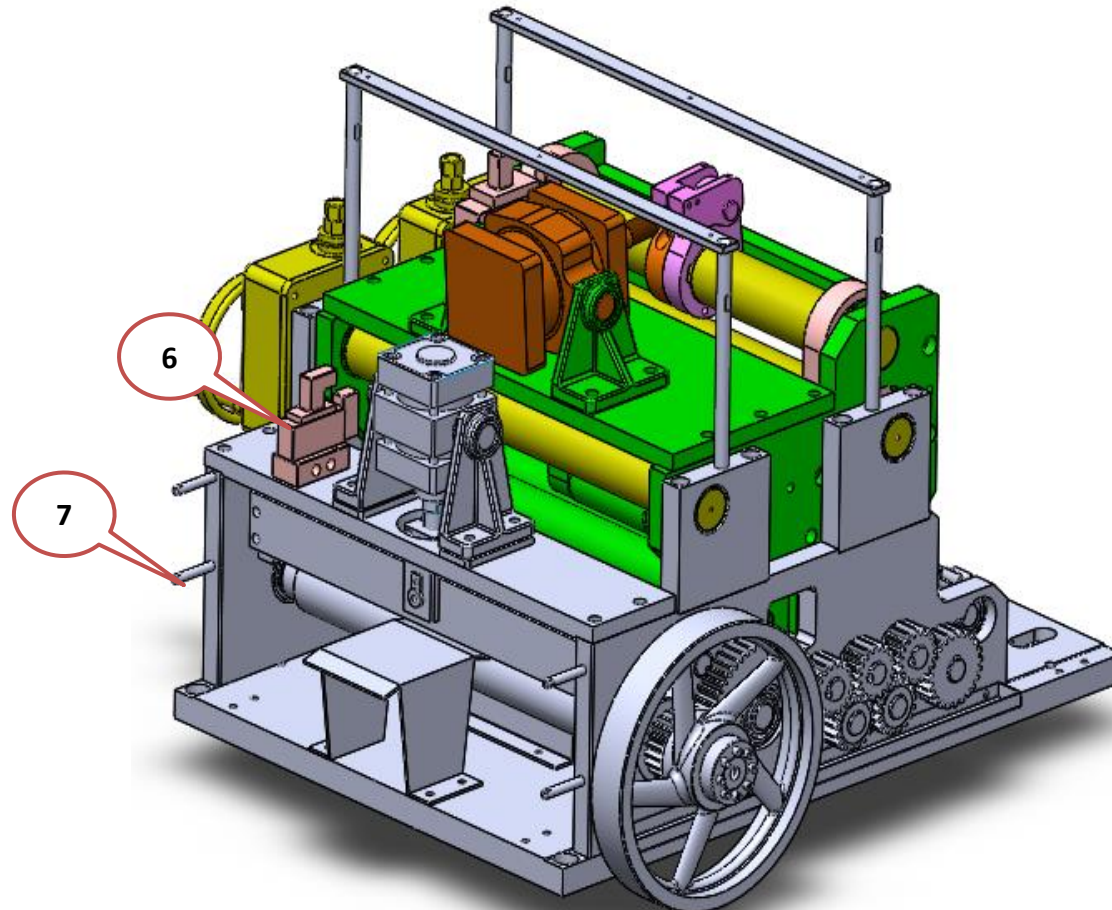
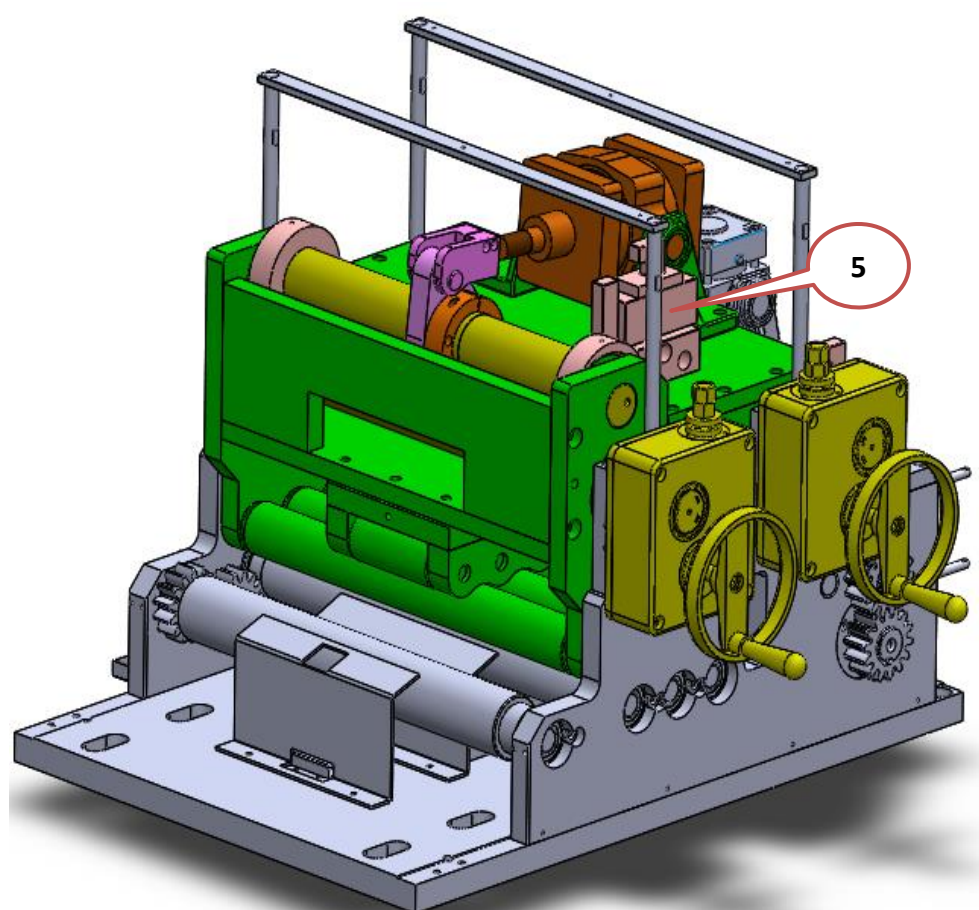
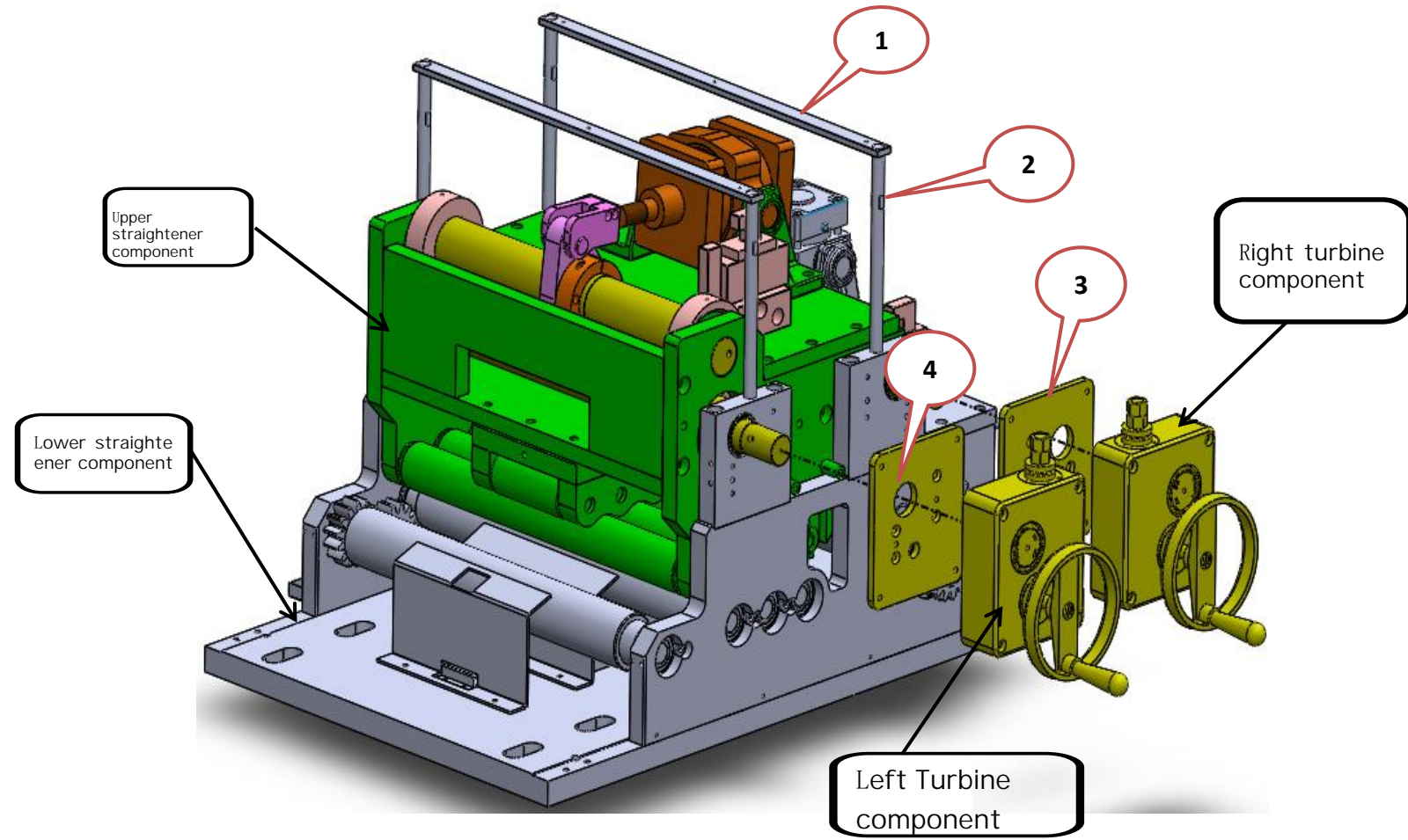

Serial number	Straightener head component/number/name
1	023-06-24037 Cover fixed board
2	023-00-24035 Cover pillar
3	003-00-24026 Right adjuster bottom plate
4	003-00-24017 Left adjustment bottom plate
5	VFS5110-5DB
6	VFS3110-5DZB
7	023-00-23049 Cover support rod
8	
9	
10	
11	
12	
13	

Straightener upper part assembly explosion view

Number of pages	13 pages, page 7	prepared by	Review	approve	
name	1、Component of upper straightener			Version	A

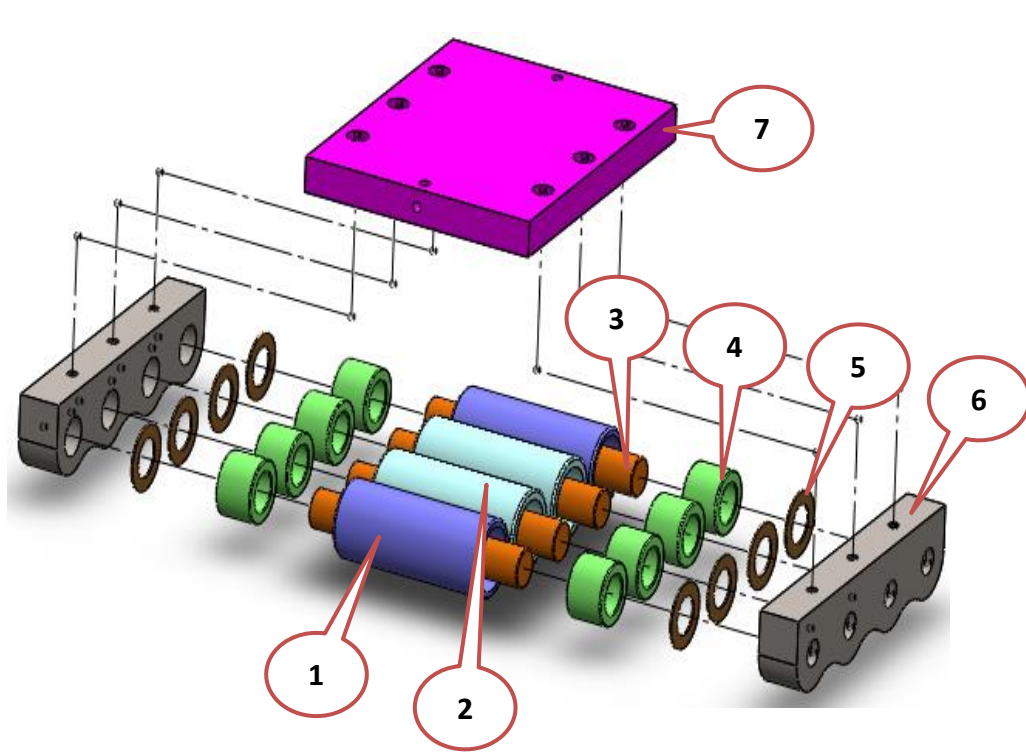

Upper auxiliary roller component

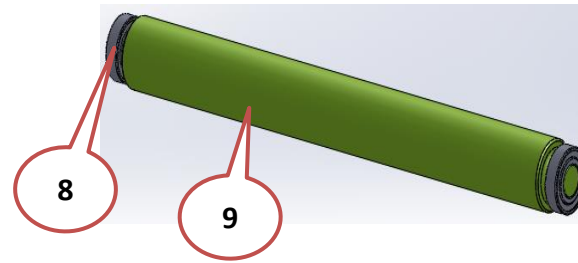

Upper straightener roller component

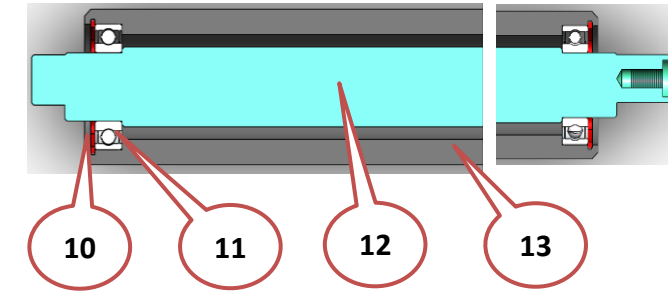

Direction roller component

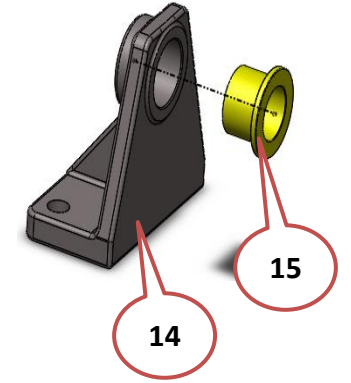

Cylinder seat component

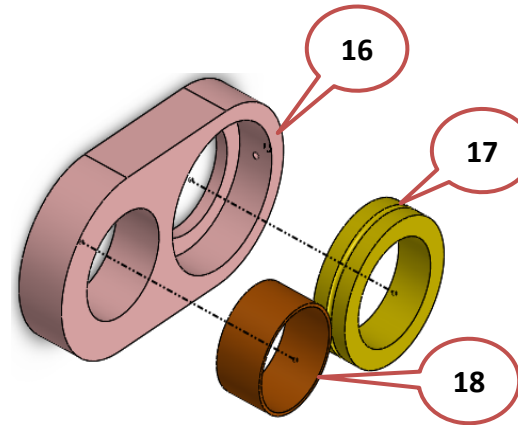

Eccentric connection rod component

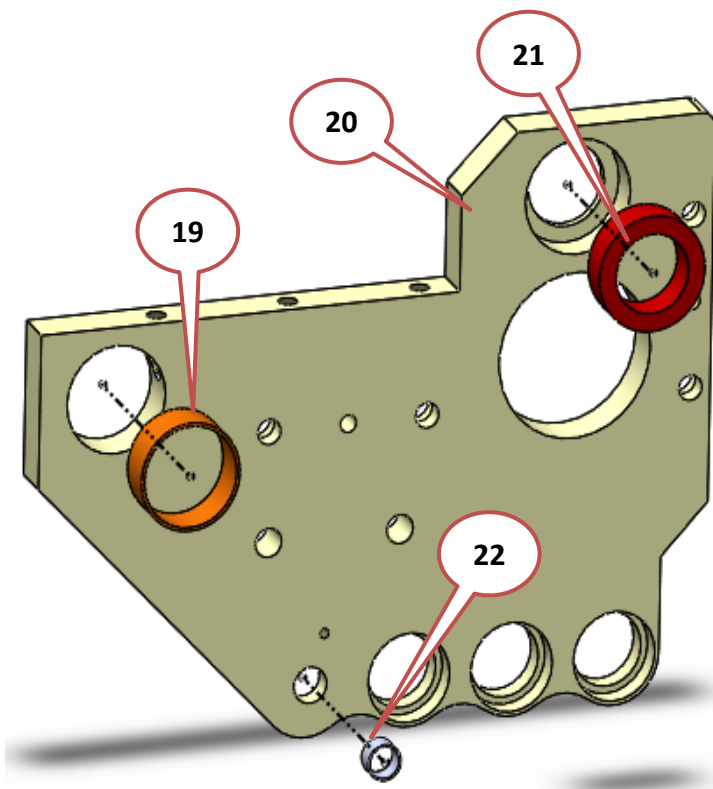

Right installation board group

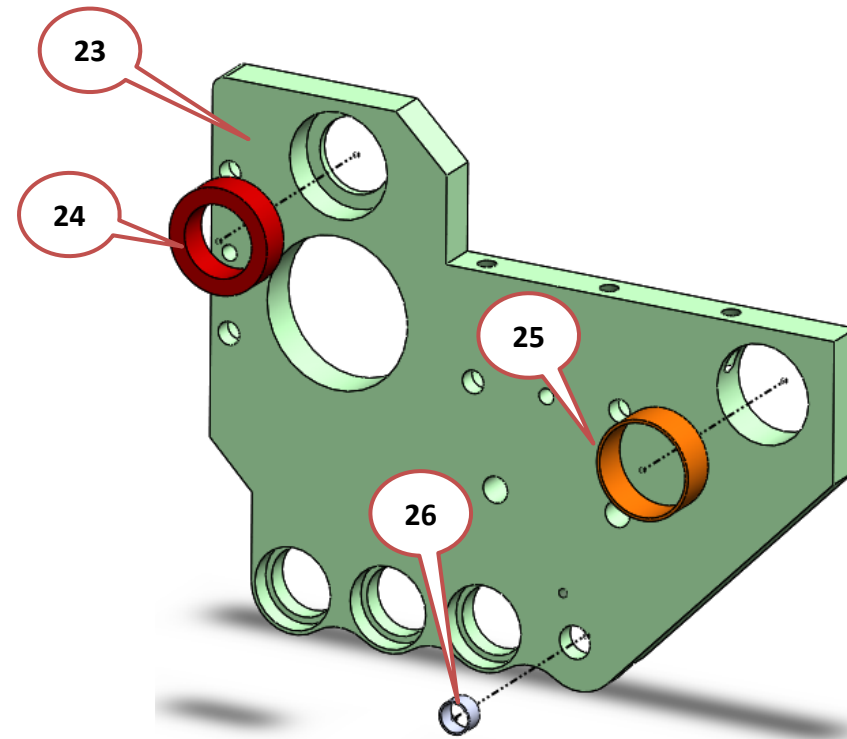

Left installation board group

Serial number	Upper straightener submachine component/number/name
1	023-00-26006 Auxiliary small roller
2	023-00-26004 Auxiliary roller
3	023-00-26003 Auxiliary shaft <5>
4	NA6932<23>
5	SF-1WC Pad (32x54x1.5)
6	023-00-26007 Upper plate
7	023-00-26005 An auxiliary board
8	Deep groove ball bearings6206-2Z
9	003-06-24001 Upper flat roller
10	GB893. 2-86Elastic block B type 55 with holes 55
11	Deep groove ball bearings6006-2Z
12	003-06-24015 Directional eccentric axis
13	003-06-24002 Straightener Direction roller
14	003-00-24006 Cylinder
15	Jdb edge inlaid set bearings (36X45X35)
16	003-00-24012 Connecting seat
17	NA4916
18	JF-800Bearing (758040)
19	FB-090Bearing (707530)
20	003-00-24003 Right installation plate
21	Roller bearingsNA4911
22	SF-1XBearing (222515)
23	Roller bearingsNA4911
24	003-00-24004 Left installation plate
25	FB-090Bearing (707530)
26	SF-1XBearing (222515)
27	
28	
29	
30	

Straightener upper part assembly explosion view

Number of pages	13 pages, page 6	prepared by	Review
name	1. Straightener upper part		approve Version
			A

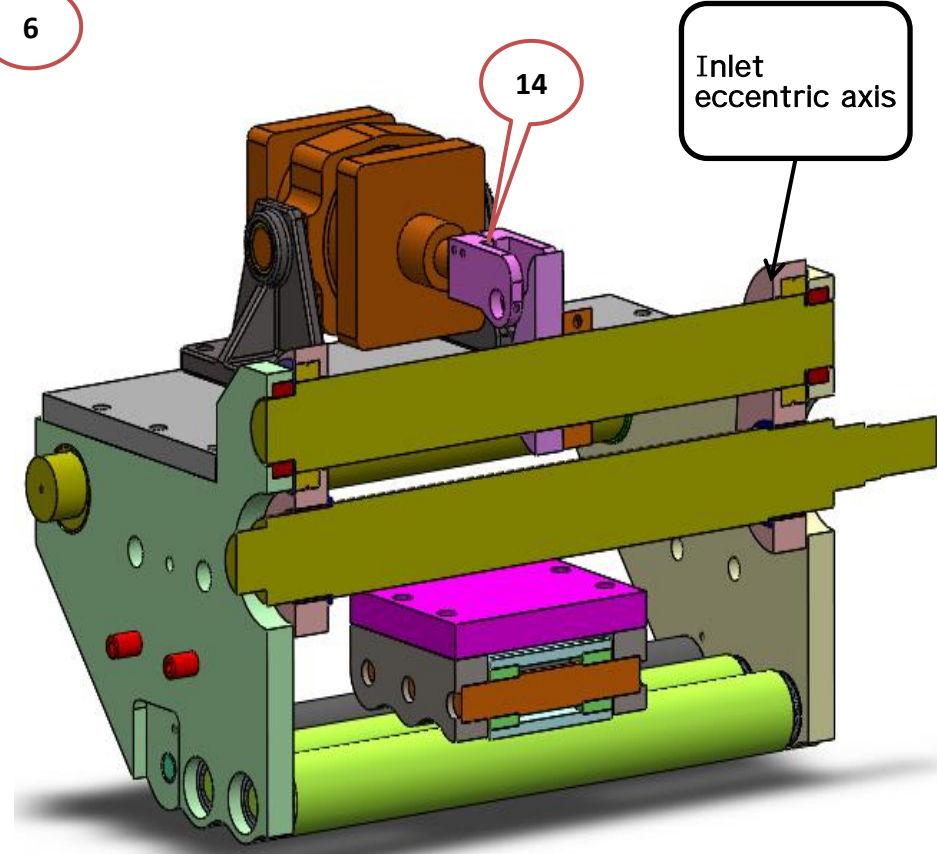
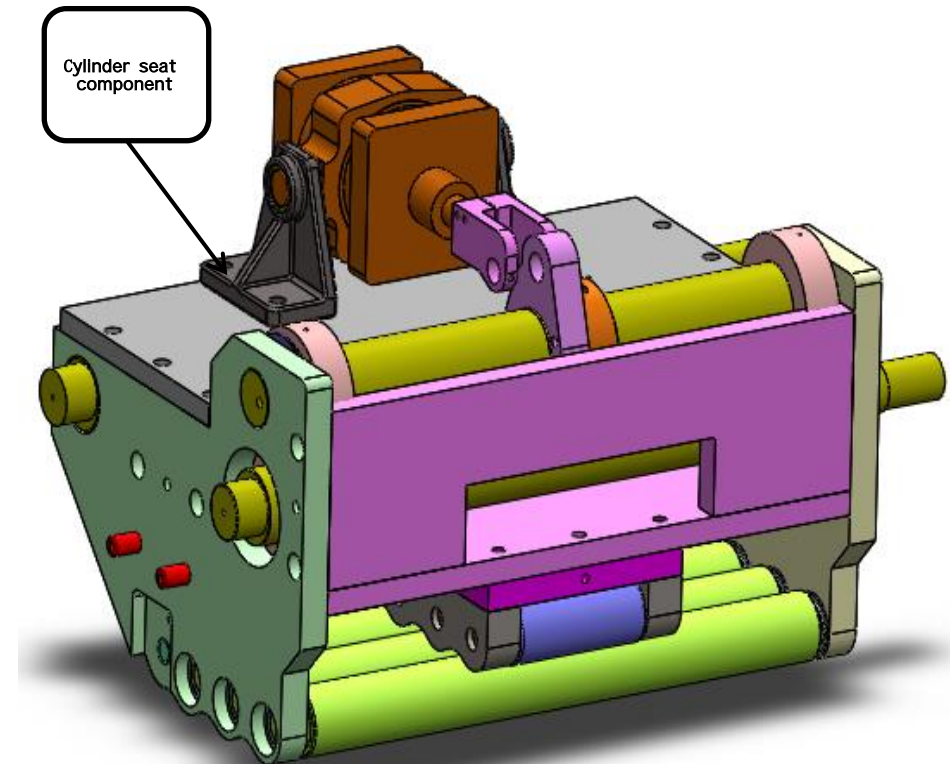
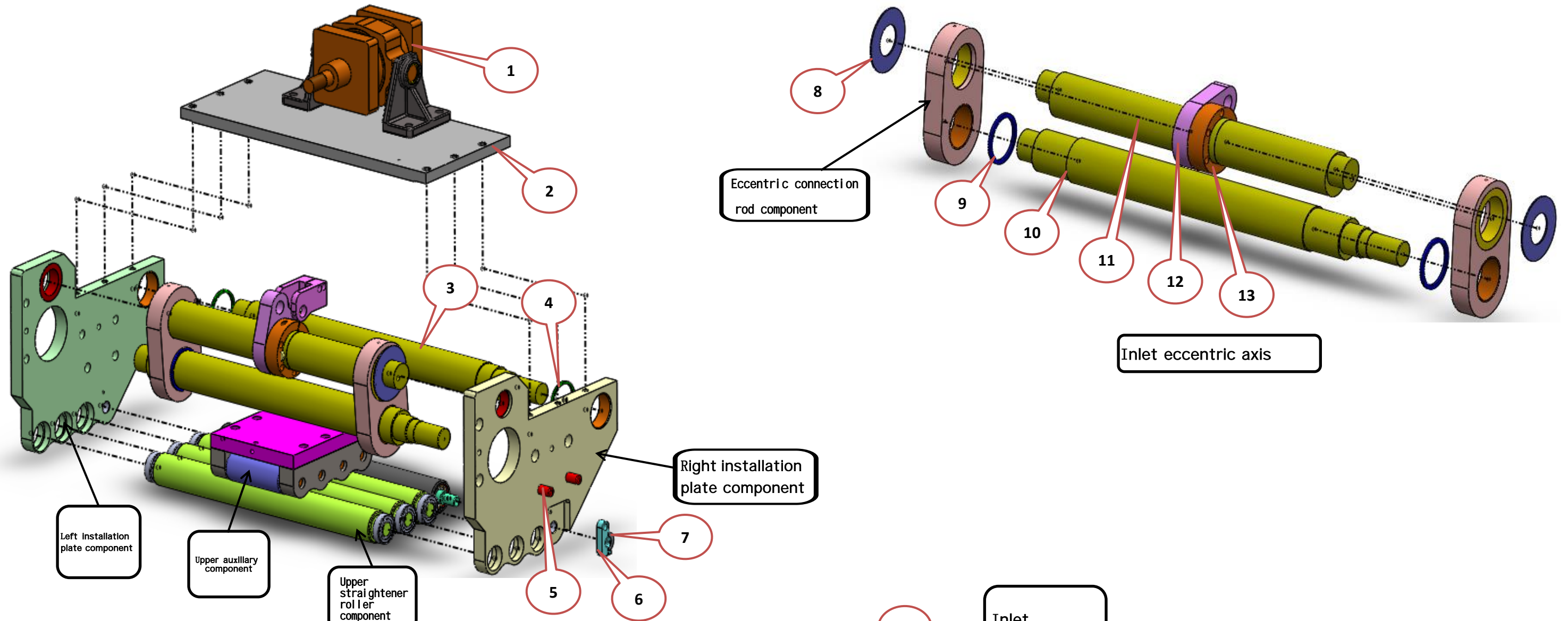

Serial number	Upper straightener sub -components/number/name
1	SCS2-TC-140B-75
2	003-06-24005 Upper panel
3	003-06-24011 Outlet eccentric axis
4	003-00-24036 Washer (2)
5	003-00-24048 Horizontal positioning
6	003-00-24029 Lock-up seat
7	Outlet ruler
8	003-00-24030 Eccentric axis washer
9	003-00-24031 Washer (1)
10	003-06-24013 Inlet eccentric axis
11	003-06-24014 Open eccentric axis
12	003-00-24032 Eccentric rocker
13	003-00-24033 Rocker lock ring
14	023-00-24046 Straightener cylinder connector
15	
16	

Straightener lower part assembly explosion view

Number of pages	13 pages, page 9	prepared by	Review	approve	
name	Straightener lower part sub-component			Version	A

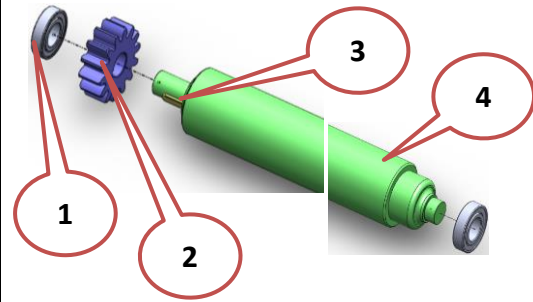

Guide press axis component

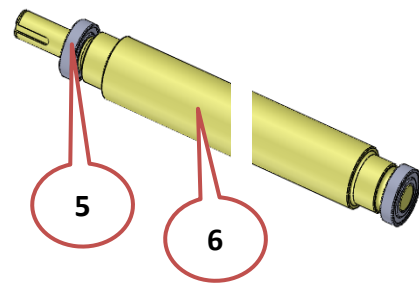

Lower straightener roller component

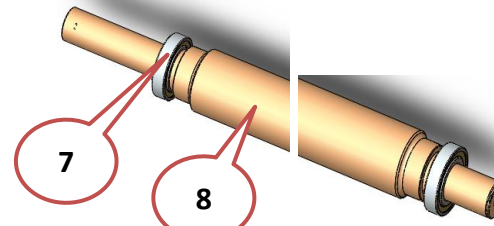

Main feeding roller component

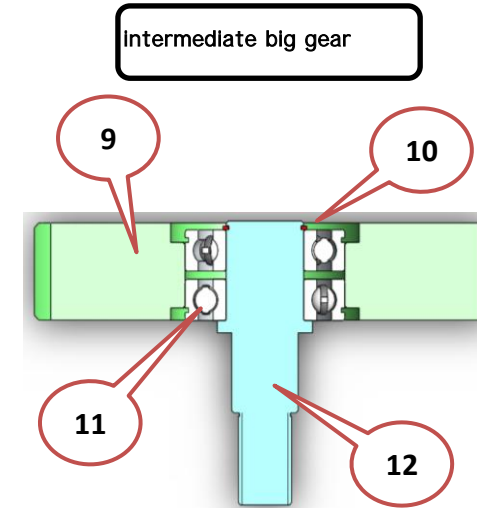

Intermediate big gear

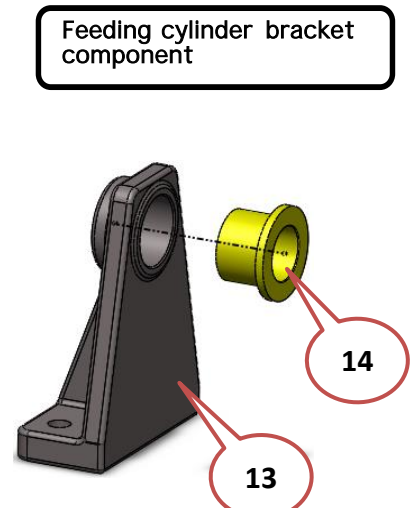

Feeding cylinder bracket component

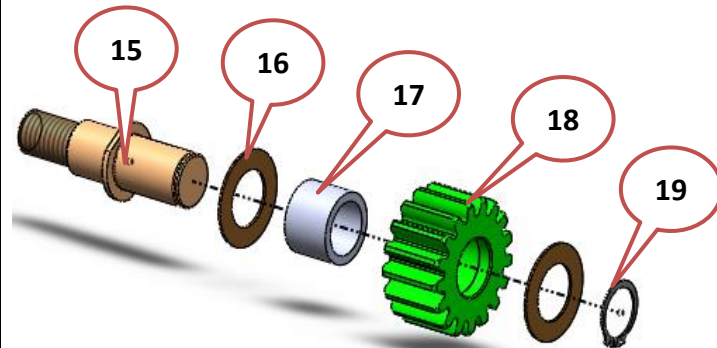

Intermediate gear component

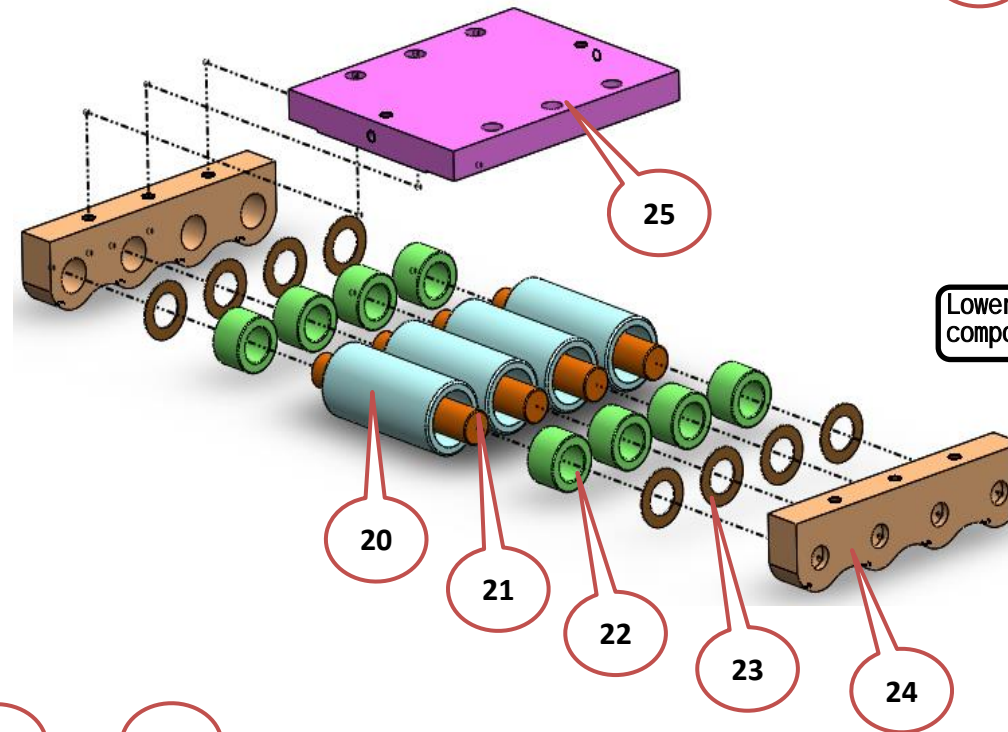

Lower auxiliary component

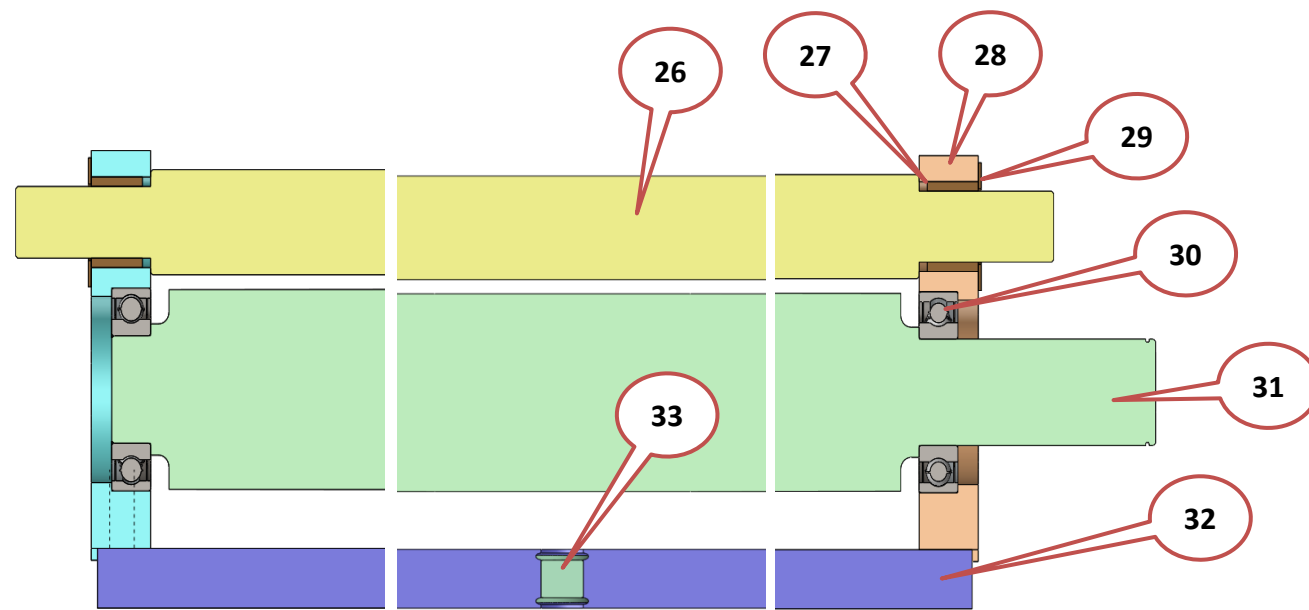

Feeding roller component

Serial number	Lower straightener sub component/number/name
1	Deep groove ball bearings 6206-2z
2	023-00-23039 Feed gear
3	GB / T1096-1979 Ordinary flat key A 10 × 361
4	023-06-23038 front guide press axis
5	Deep groove ball bearings 6206-2z
6	023-06-23003 Lower straightening Roller
7	Deep groove ball bearings 6209-2z
8	023-06-23001 Main feedingroller
9	023-00-23009 Intermediate big gear
10	GB893. 2-86Elastic block B type 35 with holes 35
11	Deep groove ball bearings 6207-nR
12	023-00-23012 Intermediate gear shaft
13	023-00-23031 Feeding air cylinder bracket (diameter 100)
14	JDB Flanging copper sleeve (35X45X35)
15	023-00-23013 Intermediate gear shaft
16	SF-1WC Pad (32x54x1.5)
17	Roller bearings TAF304030
18	023-00-23008 Intermediate gear
19	GB894. 2-86 Elastic block B type B -shaft 30
20	023-00-26004 Auxiliary roller
21	023-00-26003 Auxiliary shaft
22	NA6932
23	SF-1WC Pad (32x54x1.5)
24	023-00-26002 Lower side plate
25	023-00-26001 Down auxiliary plate
26	023-06-23004 Press Roller shaft
27	JDB-1 Bearing (303825)
28	023-00-23024-1 Roller bracket
29	SF-1WC Pad (32x54x1.5)
30	Deep groove ball bearings 6209-2z
31	023-06-23002 Feed roller
32	023-06-23029 Air Cylinder press plate
33	No refueling joint bearing(GE25EC)
34	
35	
36	

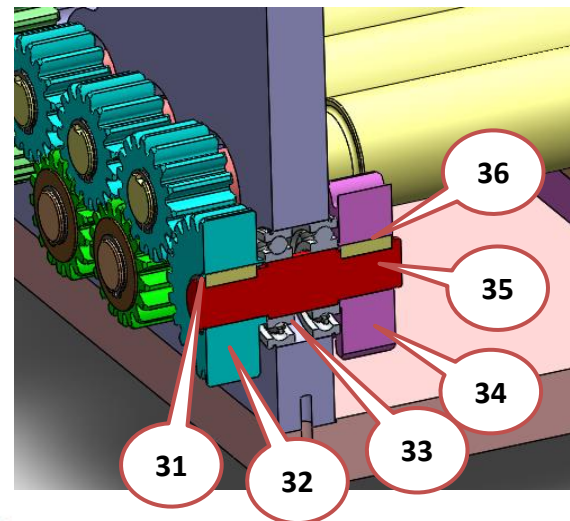
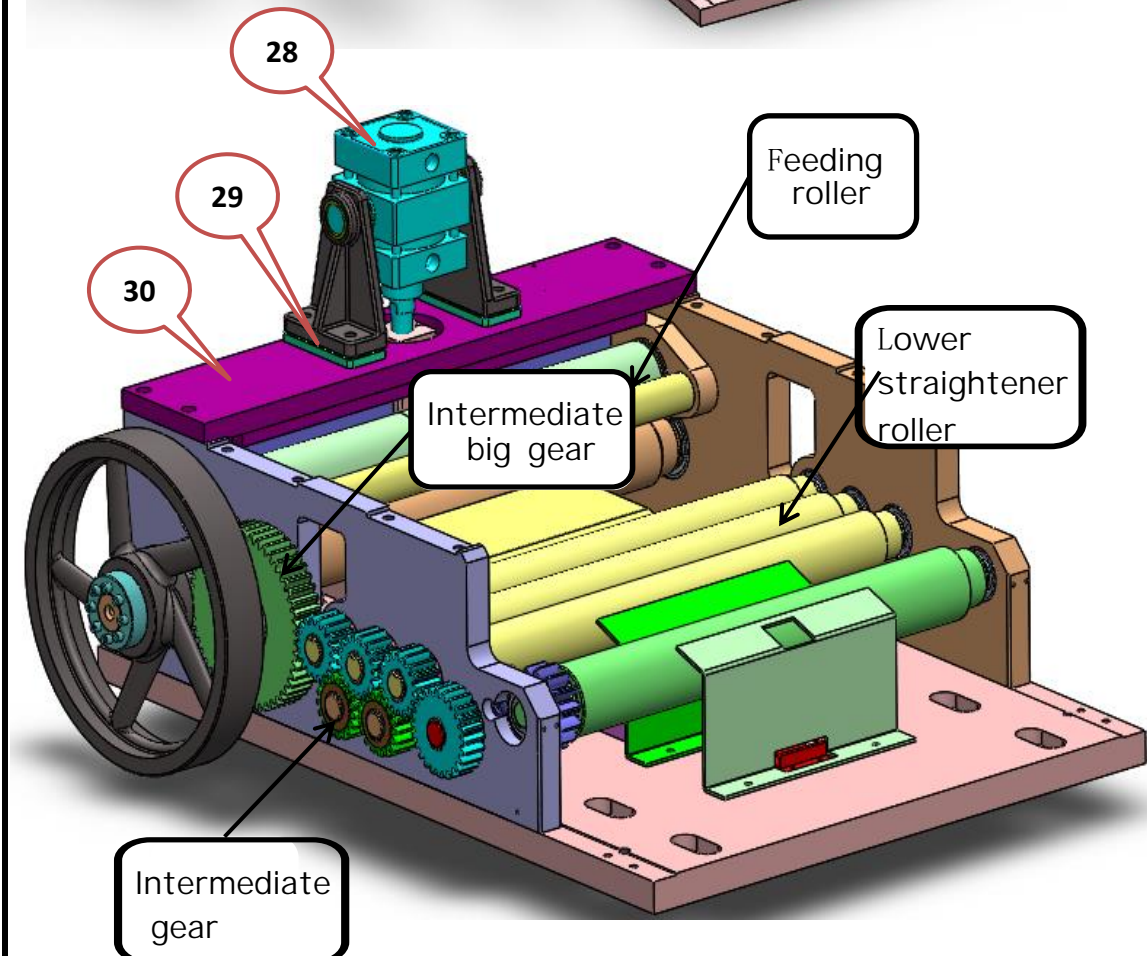
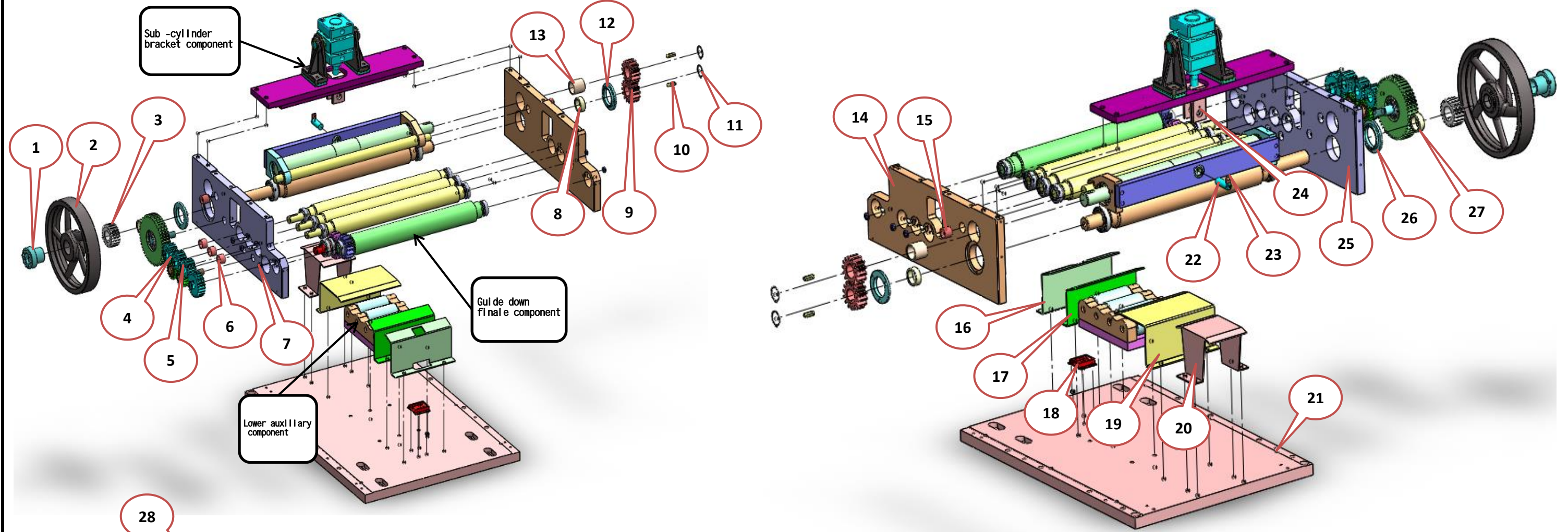

Serial number	Lower straightener sub component/number/name	Serial number	Lower straightener sub component/number/name
1	FT-K (45×59×70)	21	003-06-23006 Base plate
2	023-00-23040 Band wheel (casting)	22	023-00-23023 Plug
3	023-00-23007-02 Feed gear (2)	23	023-00-23025 Stop pad
4	023-00-23005 Press roller gear	24	023-00-23022-A1 U-shaped connector (cycling diameter 100)
5	GB894. 2-86 Elastic block B type B -shaft 30	25	023-00-23011 Left plate
6	023-00-23018 Straightener roller washer <2>	26	023-00-23016 Press cap
7	023-00-23021 The upper roller axis pressure pad <9>	27	023-00-23042 Lower driving roller washer
8	023-00-23042 Lower driving roller washer	28	SCA2-TC-100B-20
9	023-00-23007-01 Feed gear (1)	29	003-00-23050 Feeding bracket pad
10	Ordinary flat key C type 14 × 40	30	003-06-23030 Cylinder installation plate
11	GB894. 2-86 Elastic block B type B -type 45	31	GB894. 2-86 axis use elastic block B type 30
12	023-00-23016 Press cap	32	023-00-23048 Transmission gear (1)
13	023-00-23017 Lower driving roller washer	33	Deep groove ball bearings 6207-nR
14	023-00-23010 Right plate	34	023-00-23047 Transmission gear (2)
15	SF-1X Bearing (303430)	35	023-00-23046 Gear shaft
16	023-06-52006 Inlet carrier plate	36	GB/T1096-1979 Ordinary flat key A 10 × 32
17	023-06-52009 Intermediate carrier plate	37	
18	023-00-52004 Reflector plate seat	38	
19	023-06-52007 Outlet carrier plate	39	
20	023-06-52014 Outlet guide plate of end	40	

Optional Outlet guide, inlet plate assembly

Number of pages

13 pages, page 10

prepared by

Review

approve

name

1.Outlet guide components (1. Guide roller fixed bracket component, 2. Bracket component, 3. Outlet guide component), 2. Inlet plate component

Version

A

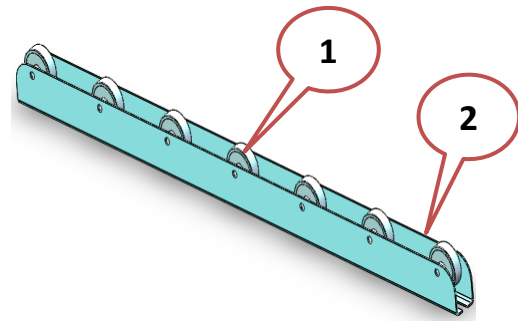

Guide wheel fixed bracket group

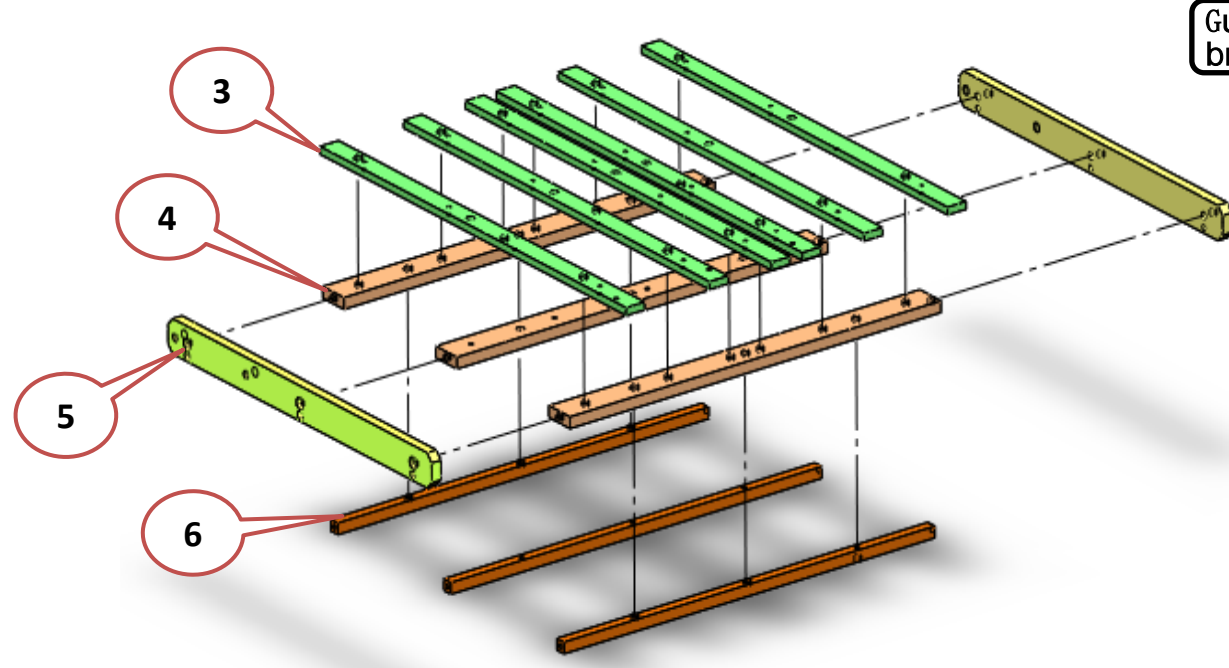

Bracket

Guide wheel fixed bracket group

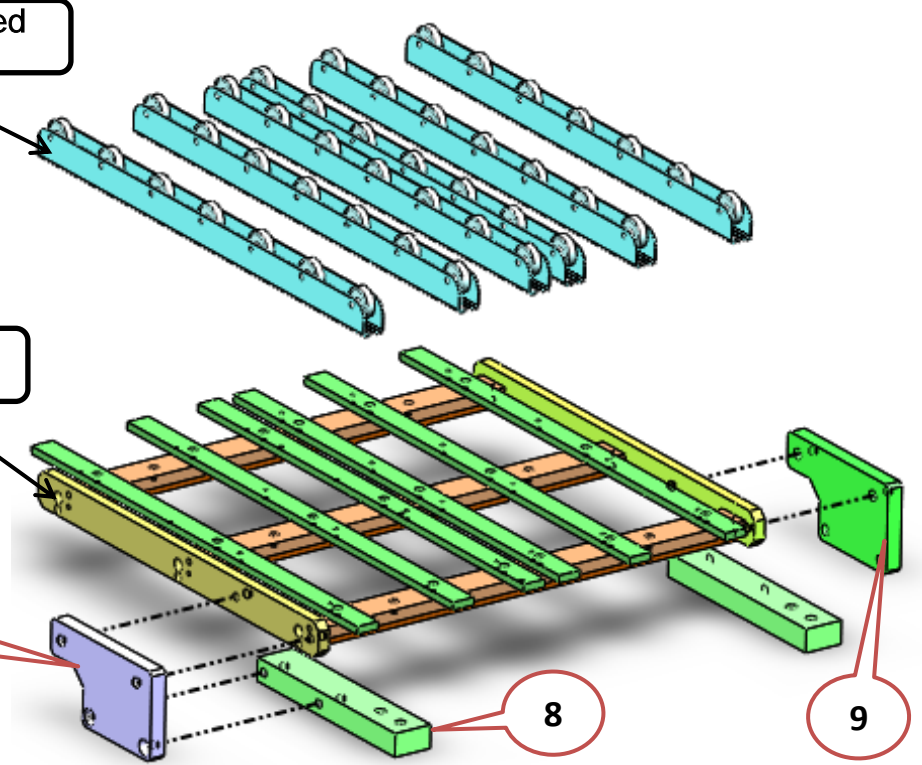

Outlet guide component

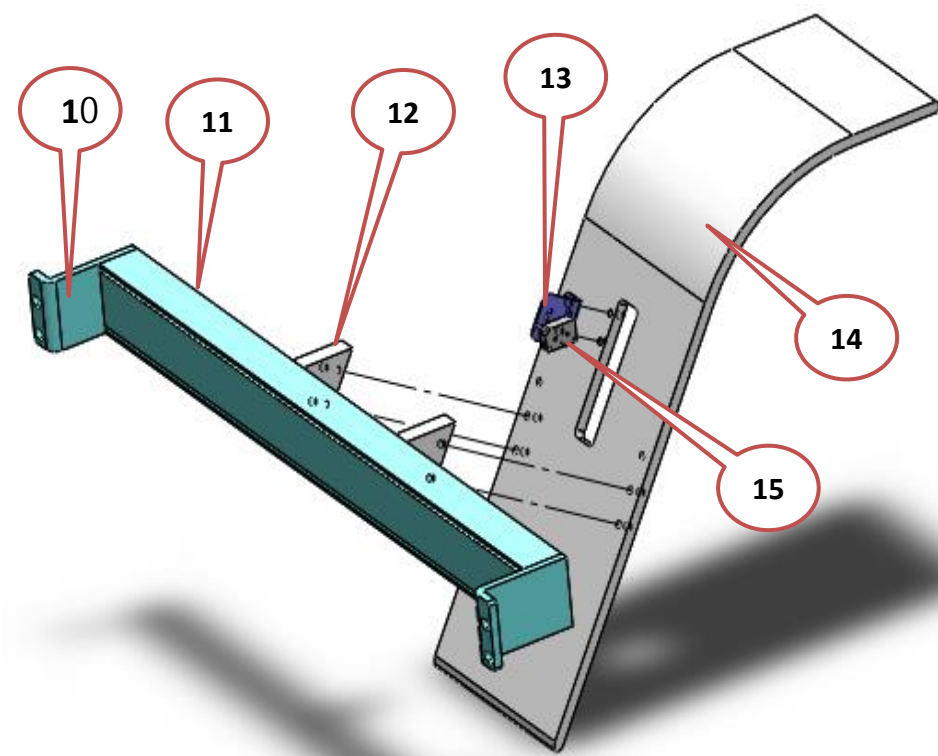

Inlet plate

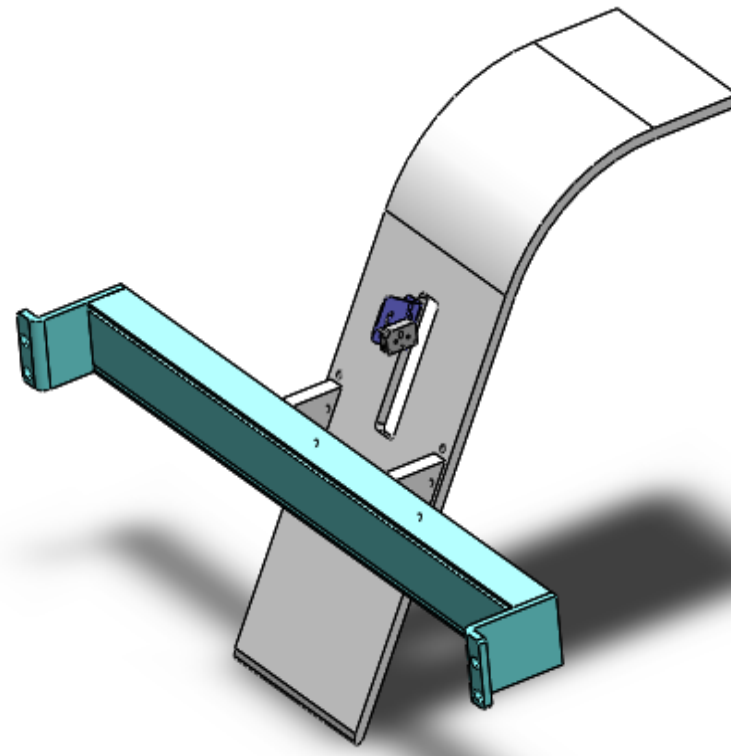

Serial number	Outlet guide parts/number/name
1	Rifle wheel HLX glue 38x8.1 (flow bar)
2	023-00-52024 Guide wheel fixed bracket
3	023-00-28004-05A Bracket fixing plate
4	1 023-06-28004-03A Bracket connect plate
5	023-00-28004-01A Bracket side board (1)
6	023-06-28004-04A Bracket reinforcement <7>
7	023-00-28002A-02 Bracket support plate (2)
8	023-00-28001B Base installation plate
9	023-00-28002A-01 Bracket support plate (1)
Serial number	Inlet plate component/number/name
10	003-00-52011-01-A1 Blockbound installation plate
11	023-06-25020 Sink Steel 6.3
12	023-00-25013 Side plate
13	023-00-52008 Photoelectric seat
14	003-00-25012 Inlet plate
15	Photoelectric Sensors E3Z-R61 2M

Inlet guide assembly explosion view

Number of pages	13 pages, pages 11	prepared by	Review	approve	
name	Inlet guide components (1. Carrier roller components, 2. Connecting plate components, 3. Feeding upper roller components)			Version	A

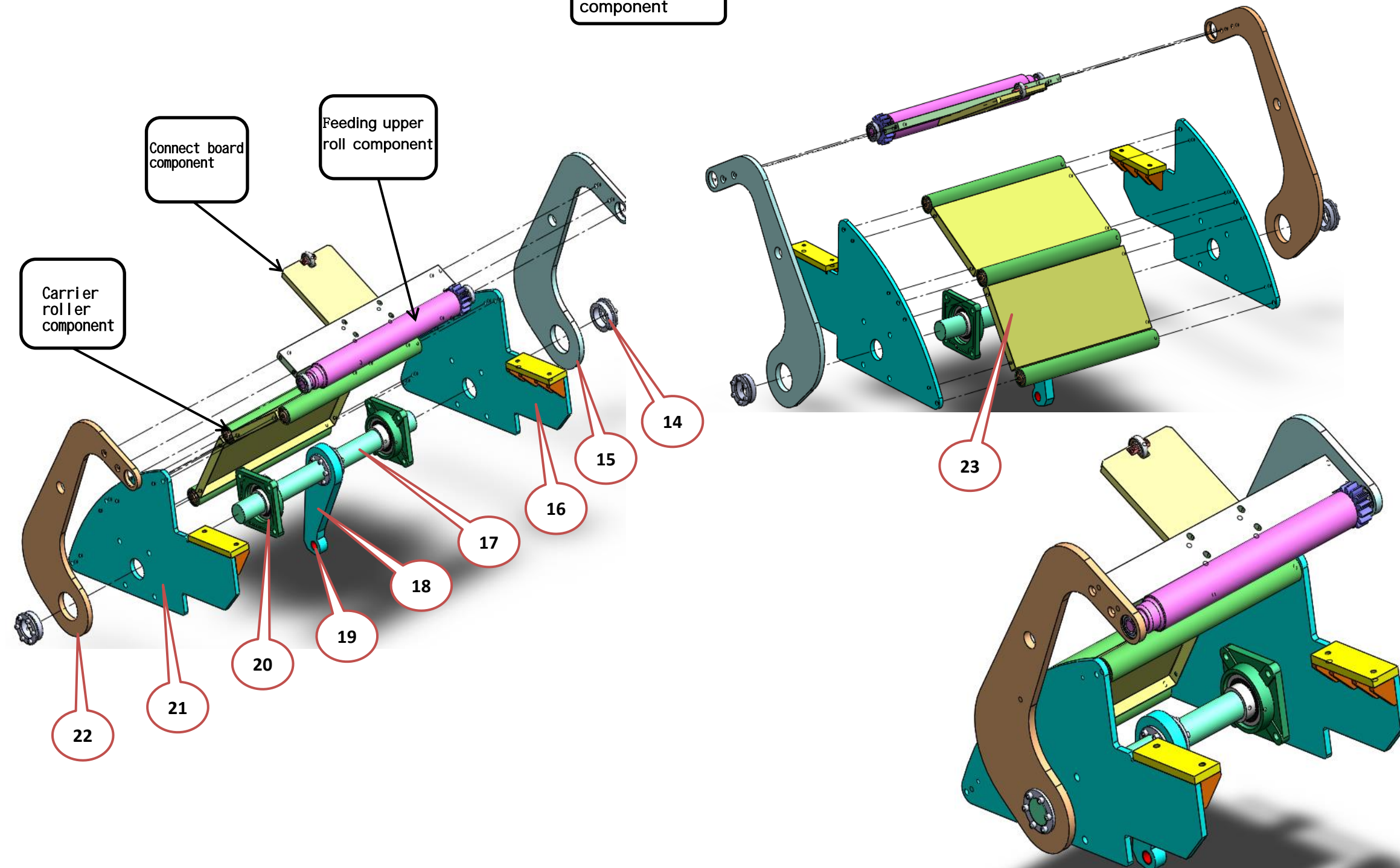
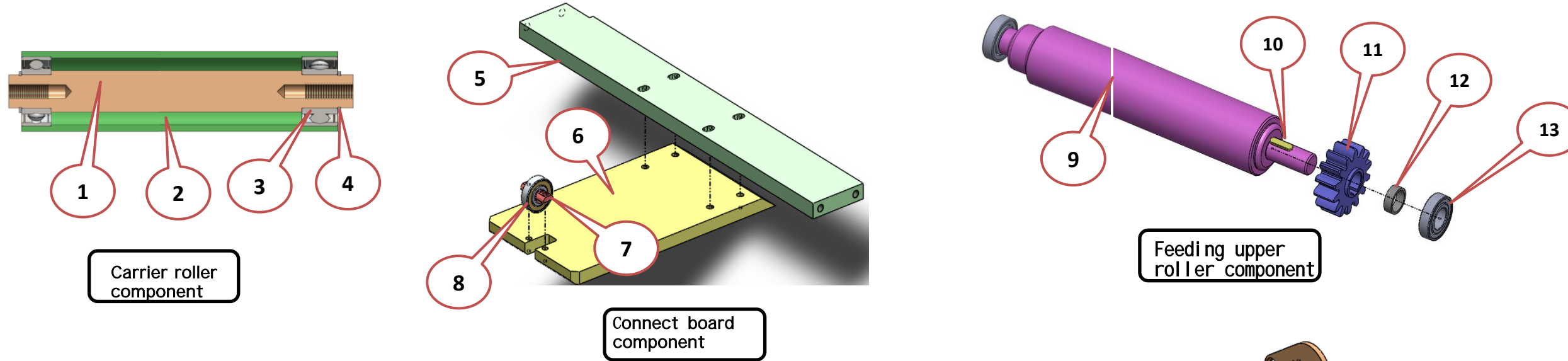

Serial number	Inlet guide component/number/name
1	023-06-25007 Carrier shaft
2	023-06-25008 Carrier Roller
3	Deep groove ball bearings6205-2Z
4	GB894.2-86 Axis use elastic block B type 25
5	023-06-25002 Connecting plate
6	023-00-25003 Front baffle
7	023-00-25004 Bearing seat
8	Deep groove ball bearings6304-2Z
9	023-06-25017 Inlet upper roller
10	GB / T1096-1979Ordinary flat key A10×36
11	023-00-23039 Feed gear
12	023-00-25018 Shaft sleeve
13	Deep groove ball bearings6206-2Z
14	FT-H03-065 (65×95×33)
15	023-00-25001-01 Folding arm (1)
16	023-00-25005-02 Inlet right side plate welded
17	023-06-25006 Folding arm shaft
18	023-00-25009 Folding arm rod
19	SF-1X Bearing (283234)
20	Square shaped seat bearing UCF213
21	023-00-25005-01 Inlet left side plate welded
22	023-00-25001-02 Folding arm (2)
23	023-06-52013 Baffle
24	
25	

Coil keeper roller assembly explosion view

Number of pages	13 pages, pages 12	prepared by		Revi ew		approve	
name	Inlet coil keeper components (1. Short direction roller components, 2. Long direction roller components, 3. Guide roller components, 4. Connect board components)				Version	A	

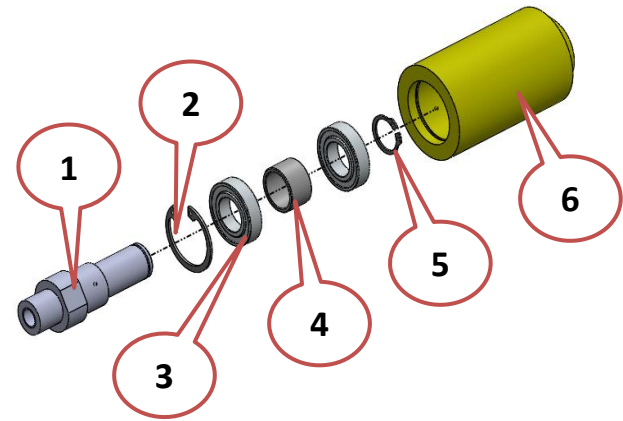

Short direction roller component

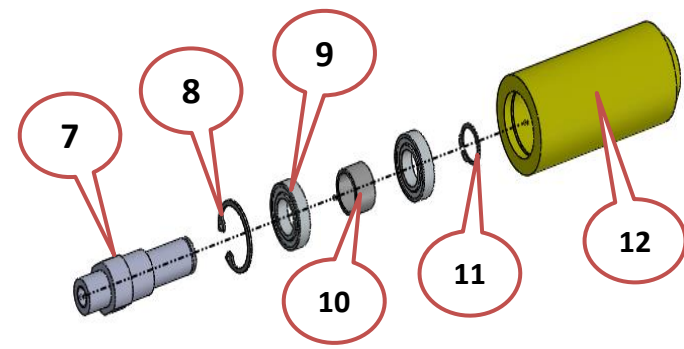

Long directional roller component

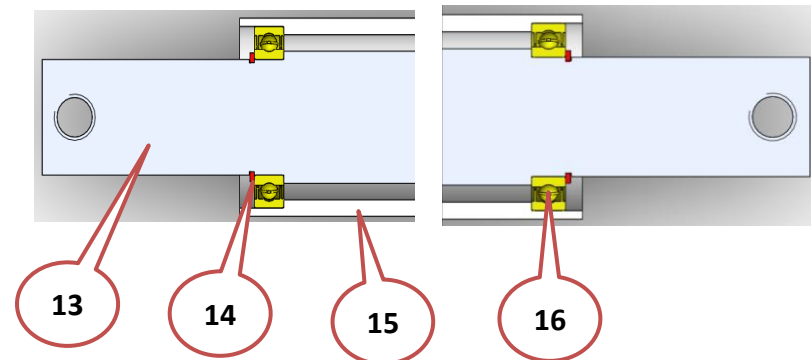

Guide roller component

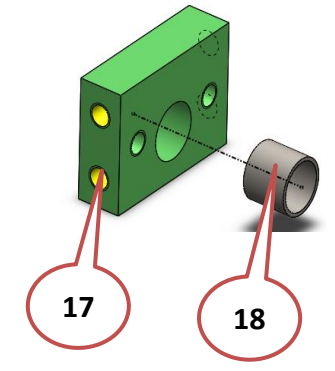

Connect board component

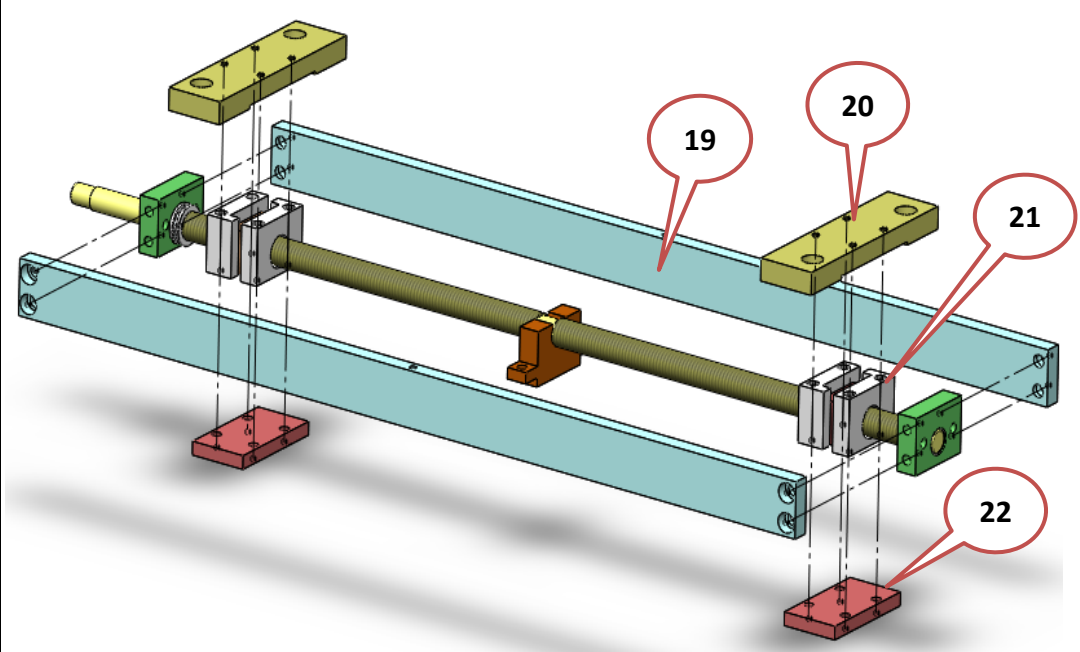

Connecting board component

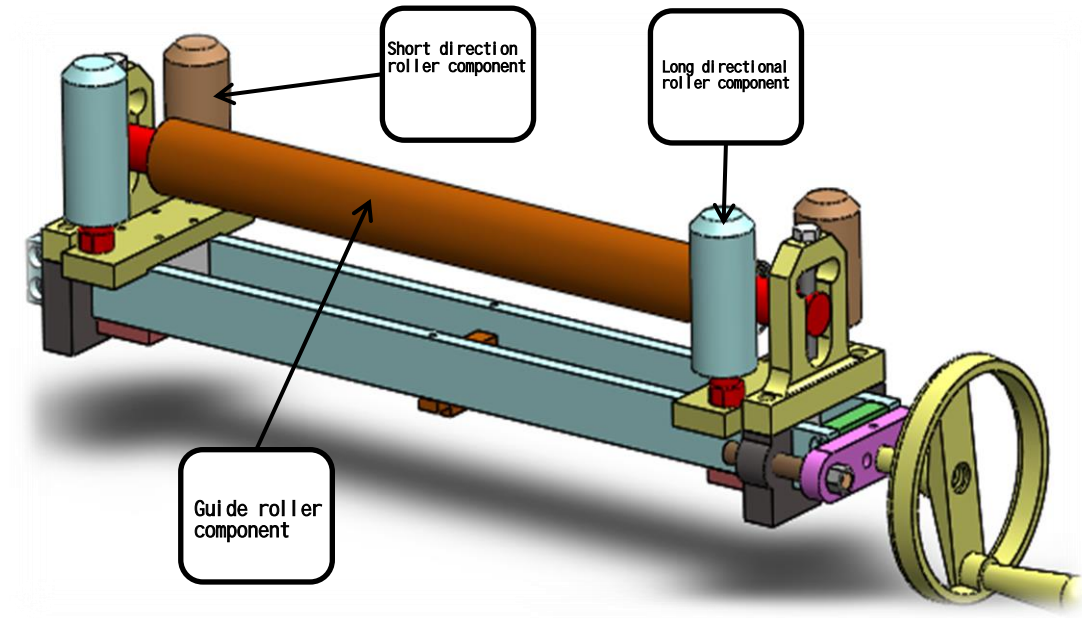
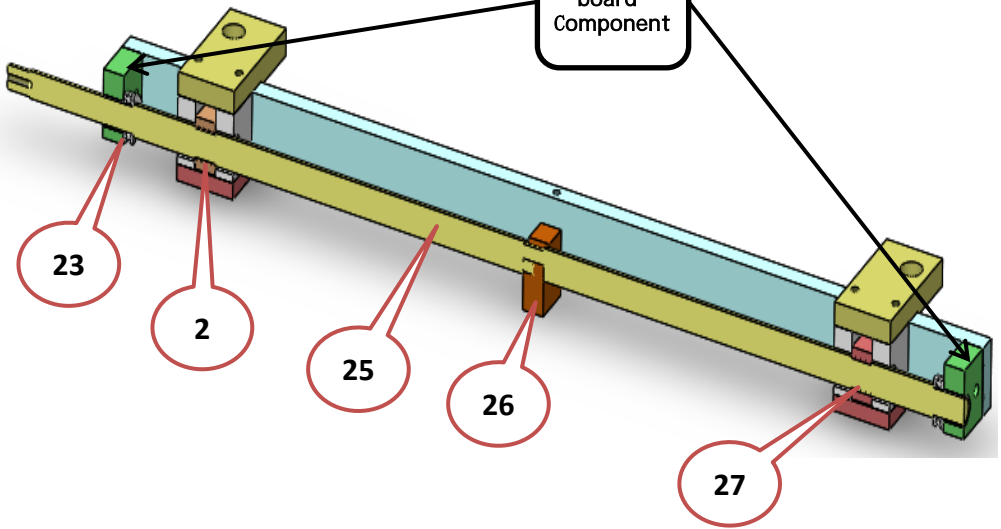

Guide roller component

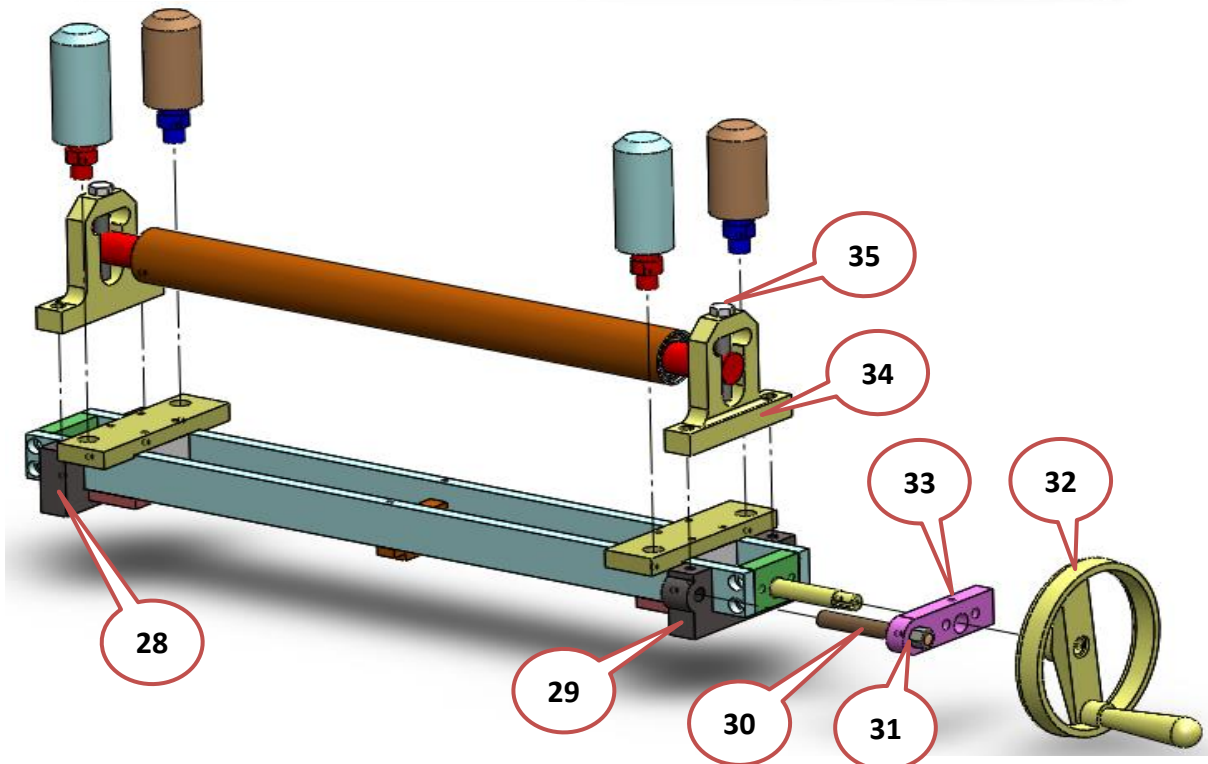

Serial number	Inlet coil keeper component/number/name
1	023-00-22014 Rear guide roller shaft
2	GB893. 2-86 Elastic block B type 37 with holes 37
3	Deep groove ball bearings 6904-2Z
4	023-00-22022 Pad
5	GB894. 1-86 Elastic block A type A type A 20
6	023-00-22011 Short direction roller
7	023-00-22015 Eccentric shaft
8	GB893. 2-86 Circlips for holes B type 37
9	Deep groove ball bearings 6904-2Z
10	023-00-22022 Pad
11	GB894. 1-86 Elastic block A type A type A 20
12	023-00-22001 Long direction roller
13	023-06-22020 Guide shaft
14	GB894. 1-86 Elastic block A type 35 of the shaft 35
15	023-06-22021 Guide roller
16	Deep groove ball bearings 6907-2z
17	023-00-22004 Connecting plate
18	SF-1X Bearing (202320)
19	023-06-22003 Guide roller board
20	023-00-22005 Guide direction roller board
21	023-00-22006 Nut press plate
22	023-00-22009 Inlet press plate
23	Thrust ball bearings 51104
24	023-00-22007 Right -rotation nut board
25	023-06-22002 Adjust screw
26	023-00-22013 Positioning press plate
27	023-00-22008 Left rotation nut plate
28	023-00-22018 Rear position block
29	023-00-22017 Front positioning board
30	023-00-22012 Adjus screw
31	Type 1 hexagonal nut C-Class (M14) [GB / T 41-2000]
32	Two -wheel spoke handleV RTP. 250A-20
33	023-00-22010 Positioning plate
34	023-00-22016 Support block
35	023-00-22019 Screw
36	