

A large industrial machine, the AZIMUTH Clinching PRESS GEN I, is shown in a studio setting. The machine is primarily black with a large, circular, dark-colored upper component. A white label with the word 'AZIMUTH' in black capital letters is mounted on the upper component. The machine has a complex mechanical structure with various pipes, valves, and a clear protective enclosure around the lower part. The background is a plain, light-colored wall.

# Clinching PRESS GEN I

## Spare parts

**Model H600 GEN I**

ITEM NO.	PART NO.	DESCRIPTION	QTY.
1	1000-002	AZIMUTH CONTROL PANEL	1
2	6-311	PUNCH MOUNTING BRACKET	1
3	6-311.1	DIE MOUNTING BRACKET	1
4	H612-001	FRAME H612	1
5	6-369AS	MOTOR ASSEMBLY	1
6	6-325AS	6T CLINCHING FLYWHEEL GUARD	1
7	6-326	6T CLINCHING FRONT GUARD	1
8	6-228	6T CLINCHING ACTUATOR GUARD	1
9	1300-018	MANUAL OILER	1
10	6-033AS	6T CRANKSHAFT ASSEMBLY	1
11	6-022	GIB, LEFT	1
12	6-022.1	GIB, RIGHT	1
13	6-315	LASER ALIGNMENT TOOL	1
14	6-341AS	6T CLINCHING FLYWHEEL ASSEMBLY	1
15	6-023AS	6T RAM ASSEMBLY	1
16	6-302.1AS	NARROW PUNCH HOLDER ASSEMBLY	1
17	6-328.1AS	Fingersafe interlock guarding	1
18	20032AS	DIE ASSEMBLY	1
19	6-306	DIE BLOCK	1
20	4-151	SOLENOID VALVE 3/2-110VAC	1
21	1310-020	MODULAR FRL 1/4NPT	1
22	6-049.1AS	6T CLINCHING MECHANICAL CLUTCH ASSEMBLY	1
23	6-149AS	PANCAKE CYLINDER ASSEMBLY	1

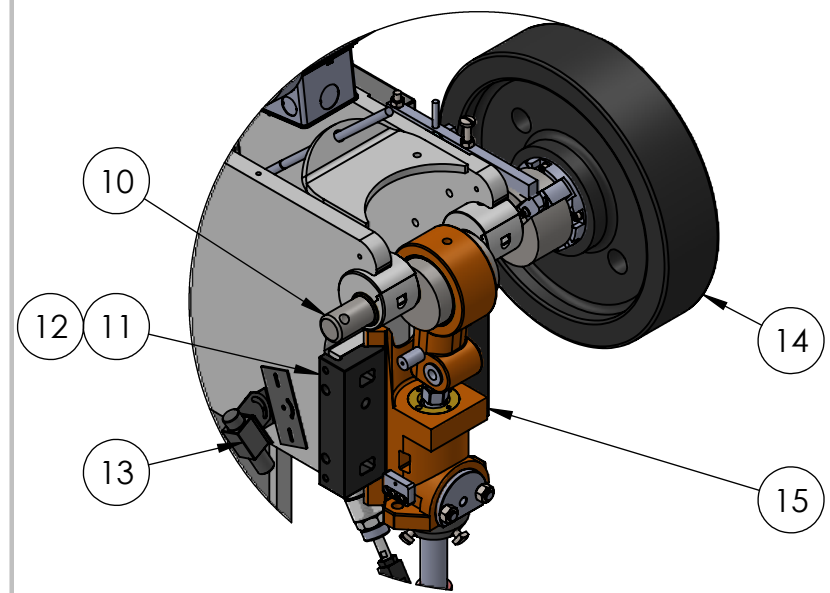
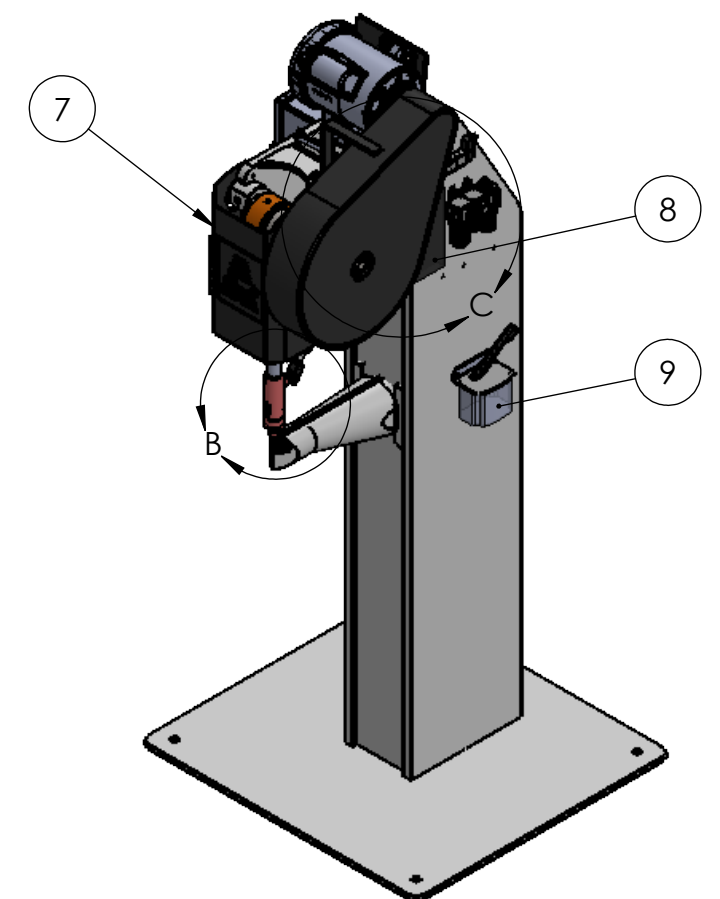
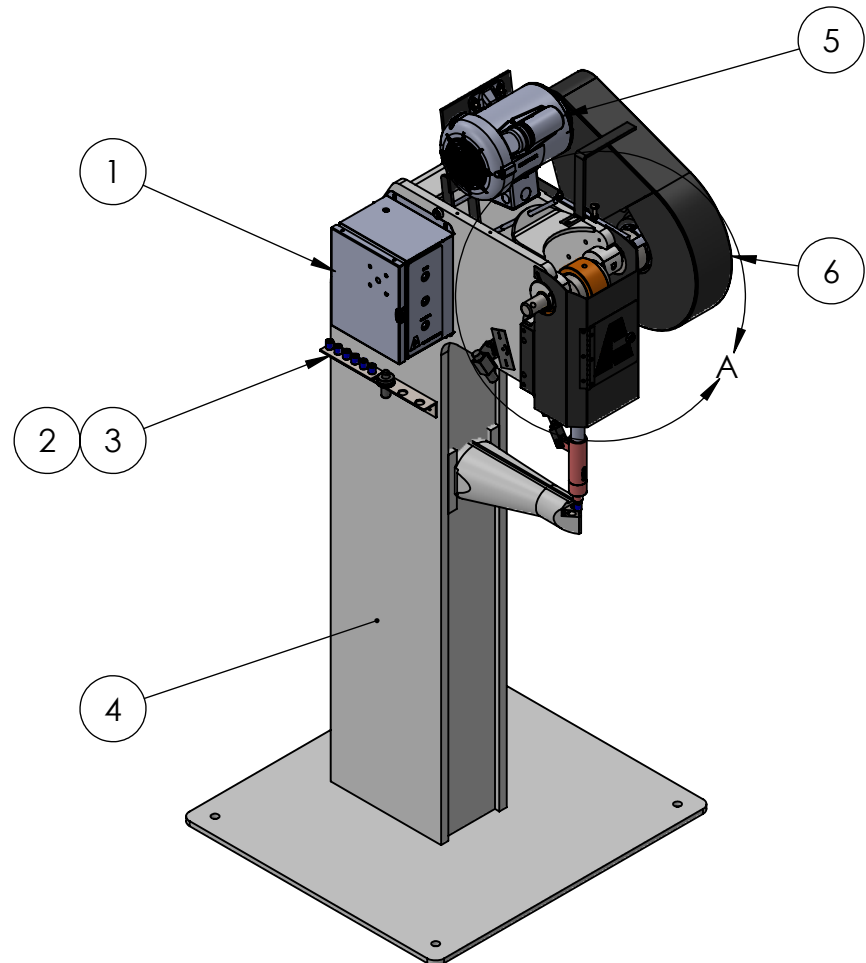

DETAIL A  
SCALE 1 : 8

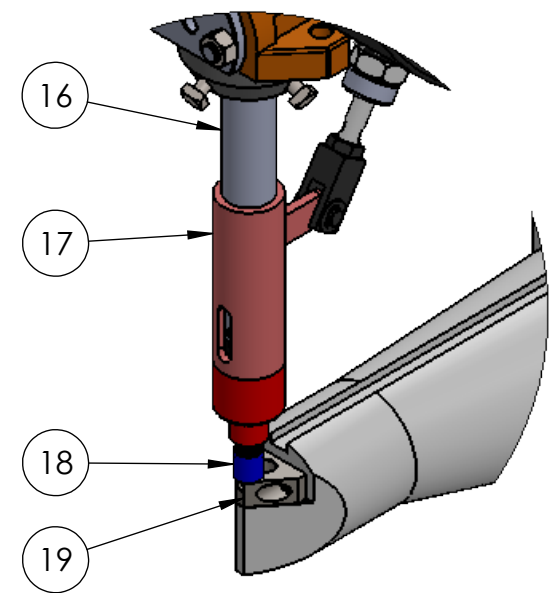

DETAIL B  
SCALE 1 : 4

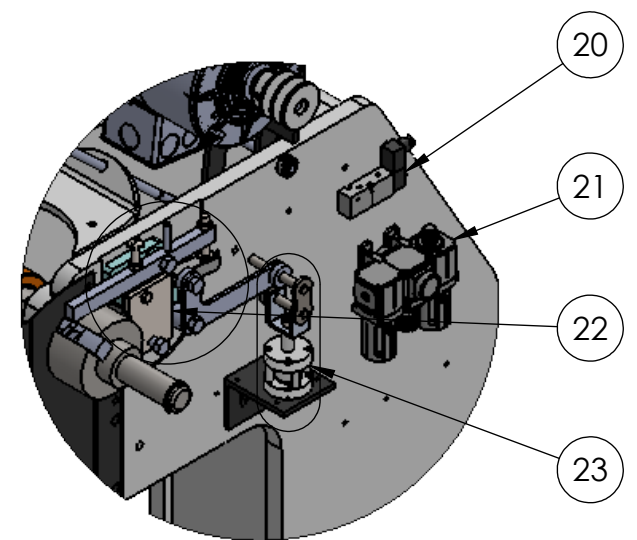

DETAIL C  
SCALE 1 : 8

\* 6-325AS (CLINCHING FLYWHEEL GUARD)  
\* 6-326 (CLINCHING FRONT GUARD)  
ARE HIDDEN IN THIS VIEW

\* 6-326 (CLINCHING FRONT GUARD)  
ARE HIDDEN IN THIS VIEW

\* 6-325AS (CLINCHING FLYWHEEL GUARD),  
\* 6-341AS (CLINCHING FLYWHEEL ASSEMBLY)  
\* 6-228 (ACTUATOR GUARD)  
ARE HIDDEN IN THIS VIEW



Azimuth Machinery Ltd  
T 450 632 8050  
F 450 632 8081  
www.azimuthpress.com  
6040 Rte. 132, Ste Catherine  
QC, Canada, J5C 1B6

DESCRIPTION	
H612	
CUSTOMER	
DRAWN BY	DATE
AZIMUTH MACHINERY	2020-02-14
ISSUED FOR	DWG. #
COMMENTS :	

**PROPRIETARY AND CONFIDENTIAL**  
THE INFORMATION CONTAINED IN THIS DRAWING IS THE SOLE PROPERTY OF AZIMUTH MACHINERY. ANY REPRODUCTION IN PART OR AS A WHOLE WITHOUT THE WRITTEN PERMISSION OF AZIMUTH MACHINERY IS PROHIBITED.

CLUTCH ADJUSTMENT PROCEDURE (IF PRESS IS DOUBLE STROKING)

1. SET TIMER RELAY INSIDE THE CONTROL PANEL TO 10S
  2. LOSSEN NUT #11
  3. BRING BOLT #10 DOWN ABOUT 1/8"
  4. PRESS & HOLD THE PEDAL TO MAKE A STROKE
  5. IF THE PRESS IS STILL REPEATING, REPEAT STEP #3&4\*. IF NOT, GO TO #6
  6. TIGHTEN THE NUT NUMBER 11
  7. SET TIMER RELAY INSIDE THE CONTROL PANEL TO 0.2S
- \*IF PRESS IS STILL REPEATING AFTER THIS PROCEDURE, VERIFY SPRING #16 (6-106), SPRING #15 (6-104) AND 6-043 ON CRANKSHAFT

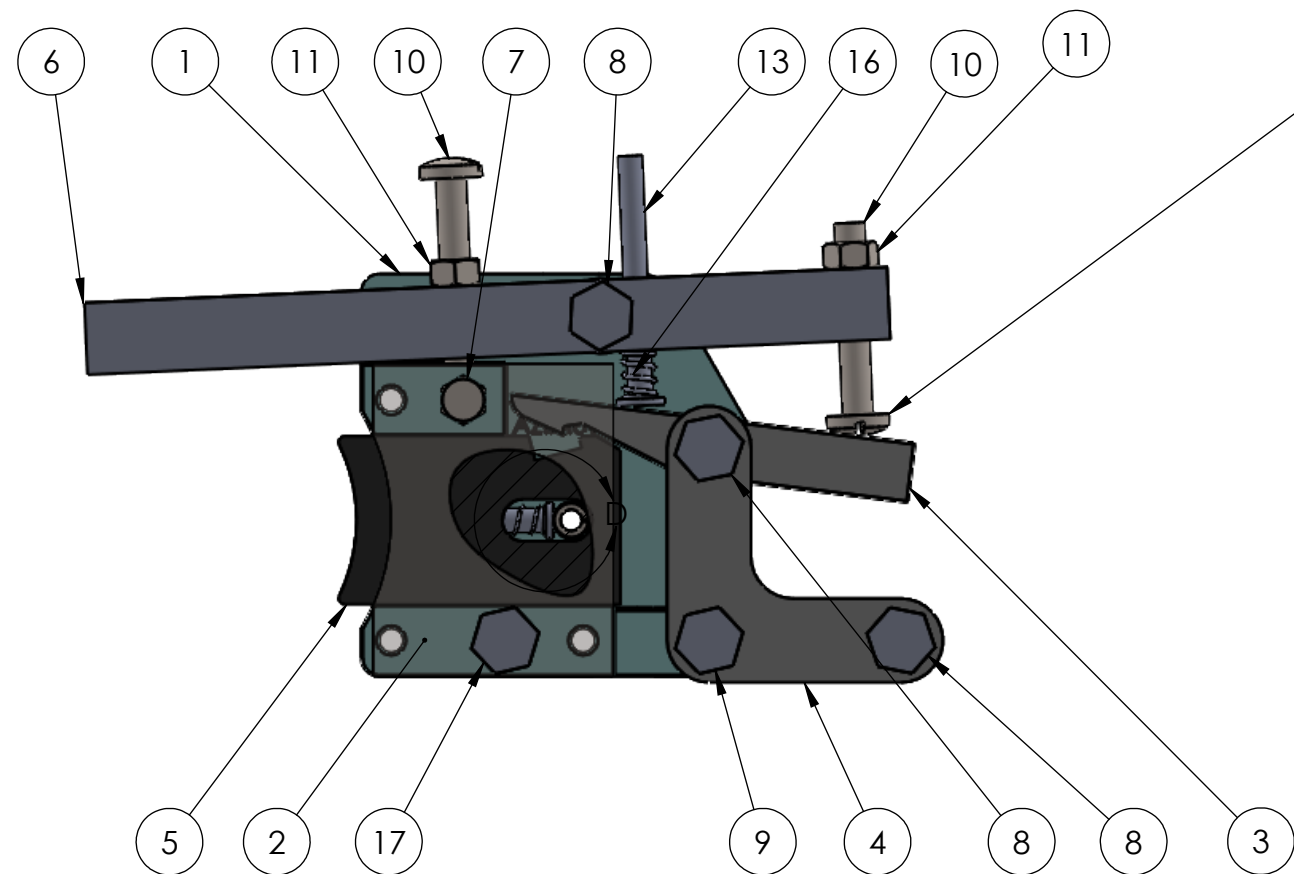

BRING THIS BOLT **DOWN** TO PREVENT DOUBLE STROKE  
BRING THIS BOLT **UP** TO DOUBLE STROKE

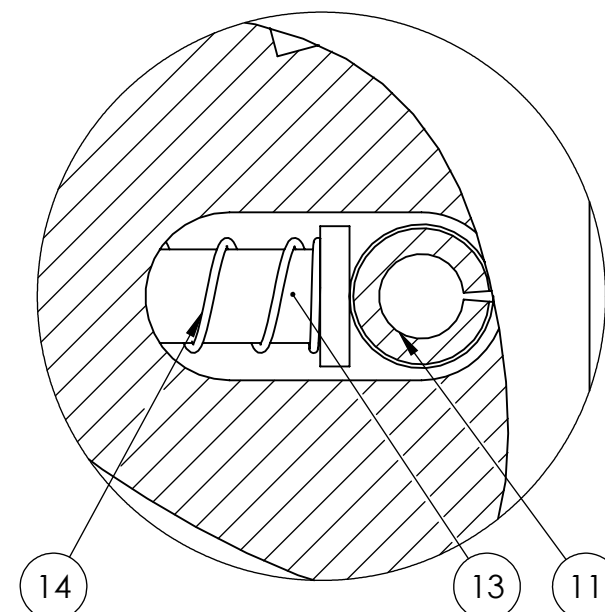
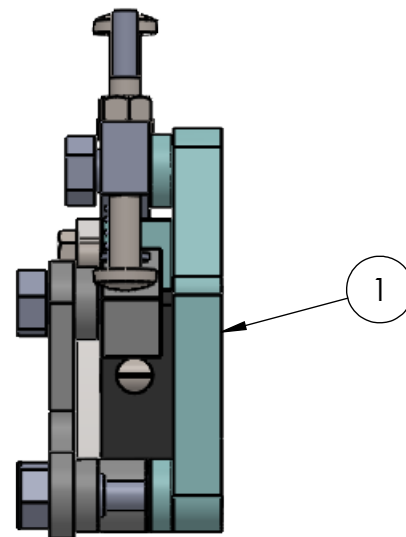

DETAIL D  
SCALE 2 : 1

ITEM NO	PART NO	DESCRIPTION	QTY
1	6-049	CLUTCH BRACKET	1
2	6-050	CLUTCH COVER PLATE	1
3	6-046	HOOK, DISENGAGING LATCH	1
4	6-055	LEVER, LATCH HOOK	1
5	6-045	DISENGAGING LATCH	1
6	6-047	RELEASE LEVER	1
7	6-053	HEX BOLT 1/4-20 X 1.5LG	1
8	6-074	SHOULDLER SCREW, CLUTCH LINKAGE	3
9	6-076	SHOULDLER SCREW, LINKAGE PIVOT	1
10	6-098	LOCKING SCREW - RELEASE LEVER	2
11	6-098.1	HEX NUT 5/16-18	2
12	6-121	SPRING PIN 0.375" X 1.25"LG	1
13	6-048	SPRING PIN, RELEASE LEVER	1
14	6-104.1	PUSHER. LATCH SPRING	1
15	6-104	SPRING, DISENGAGING LATCH	1
16	6-106	SPRING, LATCH HOOK	1
17	6-073	SHOULDLER SCREW, CLUTCH BRACKET	1



Azimuth machinery  
www.azimuthpress.com  
T 450 632 8080  
F 450 632 8081  
6040 Rte. 132  
Ste-Catherine, QC, CAN

DESCRIPTION  
MECHANICAL CLUTCH ASSEMBLY  
PART NO  
6-049AS

DRAWN BY JOEY TRUDEAU	DATE 21/21/2015
ISSUED FOR CUSTOMER REVIEW	MATERIAL

COMMENTS :

**PROPRIETARY AND CONFIDENTIAL**

THE INFORMATION CONTAINED IN THIS DRAWING IS THE SOLE PROPERTY OF AZIMUTH MACHINERY. ANY REPRODUCTION IN PART OR AS A WHOLE WITHOUT THE WRITTEN PERMISSION OF AZIMUTH MACHINERY IS PROHIBITED.

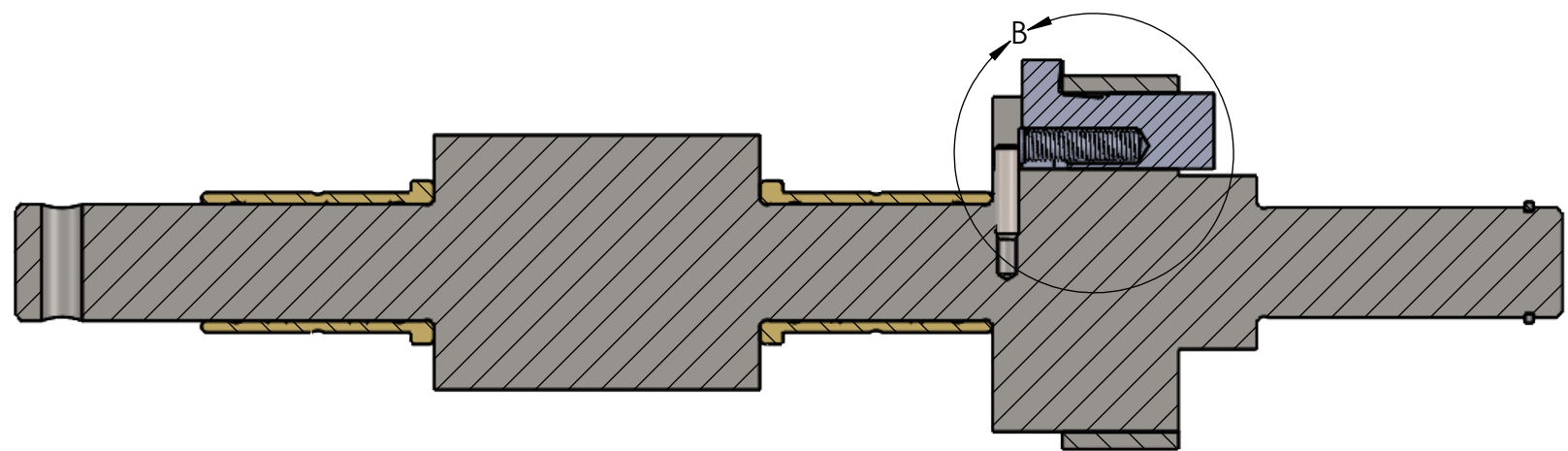

SECTION A-A

ITEM NO.	PartNo	DESCRIPTION	QTY.
1	6-034SO	6T BRONZE BUSHING, SOLID	1
2	6-033	6T CRANKSHAFT	1
3	6-034SP	6T BRONZE BUSHING, SPLIT	1
4	6-101	6T CRANKSHAFT RETAINING RING	1
5	6-086	SET SCREW 1/4-20X1 LG.	1
6	6-044	6T PUSHER, KEY SPRING	1
7	6-043	6T SLIDING KEY (CLUTCH DOG)	1
8	6-042	6T CLUTCH DOG	1

FOR DIFFERENT SIZE PRESSES, CHANGE THE FIRST DIGIT  
 EX : 6-033 IS A 6T CRANKSHAFT  
 10-033 IS A 10T CRANKSHAFT

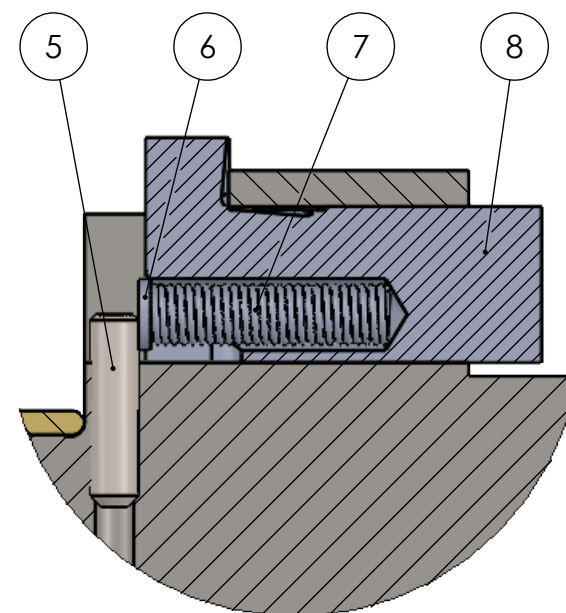

DETAIL B  
 SCALE 1 : 1

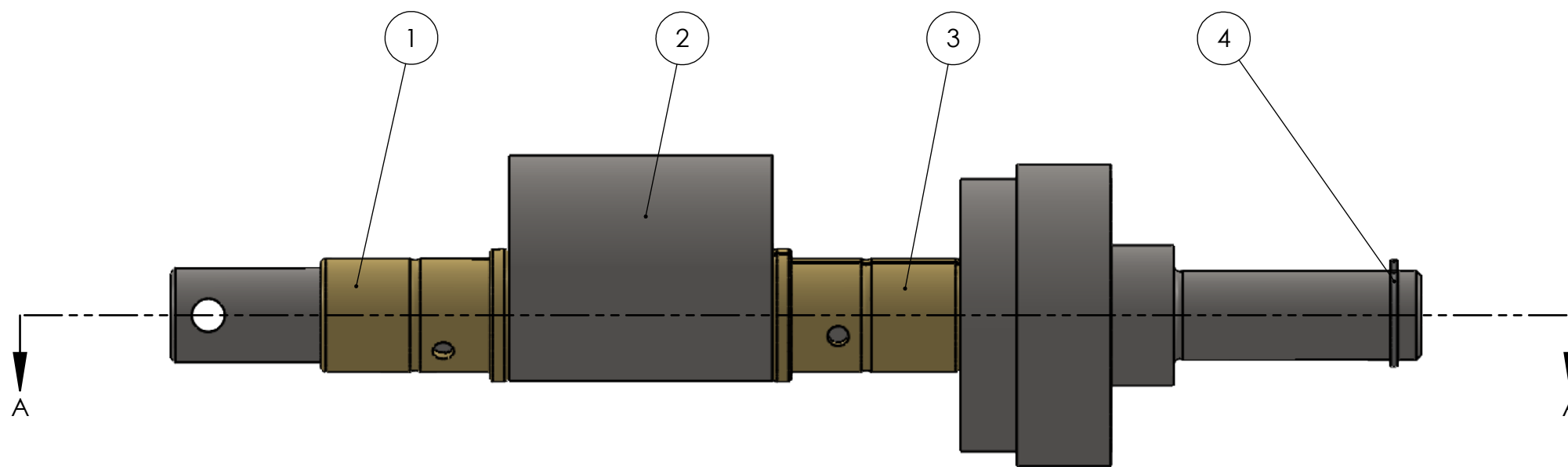
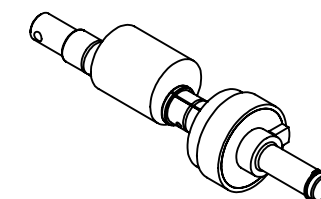

Azimuth Machinery Ltd  
 T 450 632 8080  
 F 450 632 8081  
 www.azimuthpress.com  
 6040 Rte. 132, Ste Catherine  
 QC, Canada, J5C 1B6

DESCRIPTION	
6T CRANKSHAFT ASSEMBLY	
CUSTOMER	
DRAWN BY	DATE
AZIMUTH MACHINERY	2018-04-16
ISSUED FOR	DWG. #

COMMENTS :

**PROPRIETARY AND CONFIDENTIAL**  
 THE INFORMATION CONTAINED IN THIS DRAWING IS THE SOLE PROPERTY OF AZIMUTH MACHINERY. ANY REPRODUCTION IN PART OR AS A WHOLE WITHOUT THE WRITTEN PERMISSION OF AZIMUTH MACHINERY IS PROHIBITED.

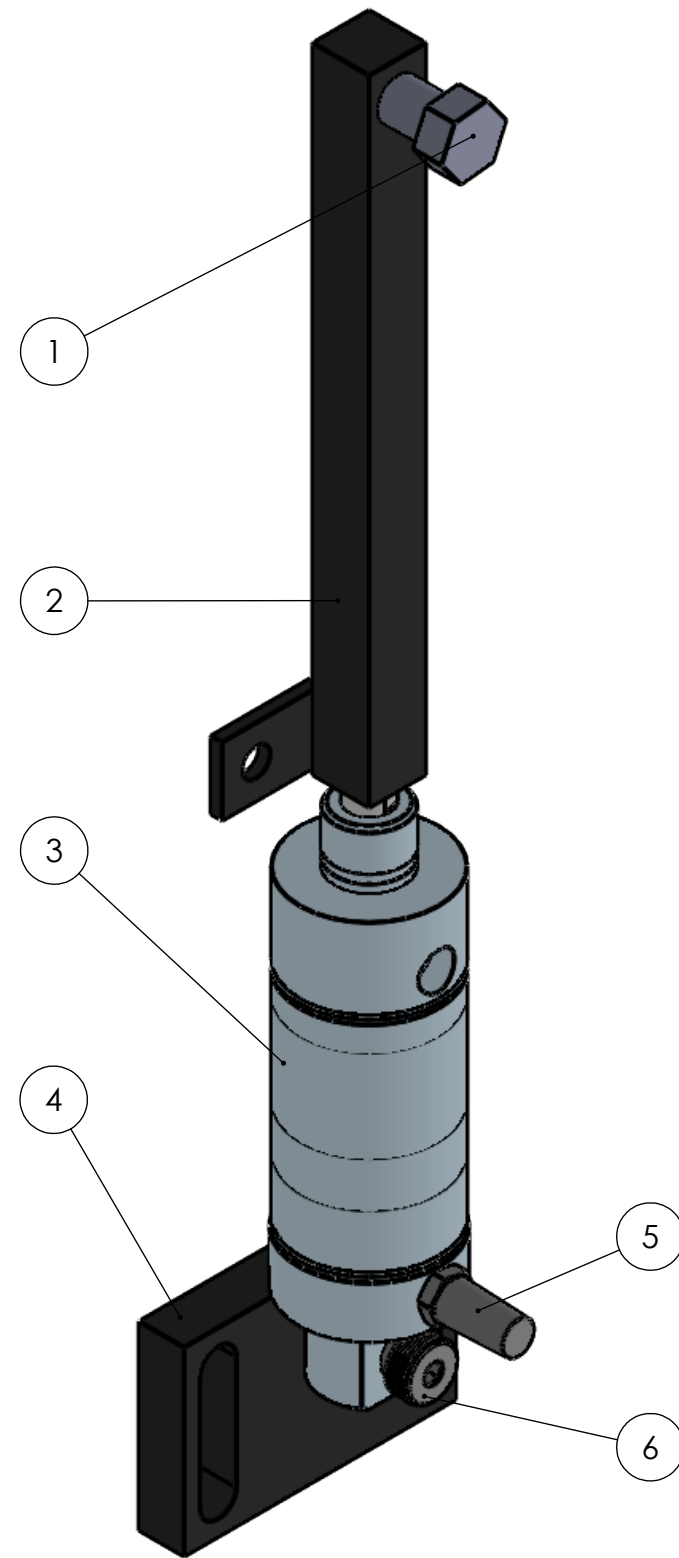

ITEM NO.	PartNo	DESCRIPTION	QTY.
1	6-074	1/2 LG. SHOUDLER SCREW	1
2	6-057	6T PULL ROD	1
3	6-150	AIR CYLINDER	1
4	4-204	4T AIR CYLINDER MOUNTING BRACKET	1
5		MUFFLER 1/8NPT	1
6		SHOULDER SCREW 3/8-16, $\phi$ 3/8" X 1" LG.	1

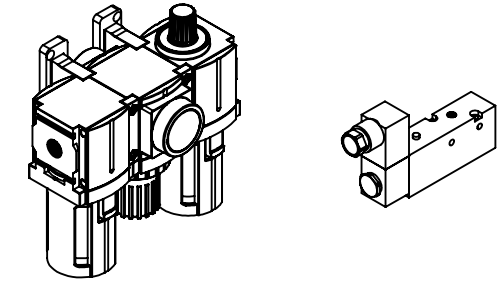

\*THIS ASSEMBLY COMES WITH PARTS :  
 4-151 SOLENOID VALVE  
 1300-020 MODULAR FRL 0.25NPT



Azimuth Machinery Ltd  
 T 450 632 8080  
 F 450 632 8081  
 www.azimuthpress.com  
 6040 Rte. 132, Ste Catherine  
 QC, Canada, J5C 1B6

DESCRIPTION	
AIR CYLINDER ASSEMBLY	
CUSTOMER	
DRAWN BY	DATE
AZIMUTH MACHINERY	2018-04-23
ISSUED FOR	DWG. #
	6-150AS
COMMENTS :	

**PROPRIETARY AND CONFIDENTIAL**  
 THE INFORMATION CONTAINED IN THIS DRAWING IS THE SOLE PROPERTY OF AZIMUTH MACHINERY. ANY REPRODUCTION IN PART OR AS A WHOLE WITHOUT THE WRITTEN PERMISSION OF AZIMUTH MACHINERY IS PROHIBITED.

NOTE	DESCRIPTION
1	MAKE SURE TO ALWAYS TIGHTEN SET SCREWS #11 AFTER REPLACING PART #10 (6-026). TO READJUST CUP-BALL ADJUSTMENT, LOOSEN UP SCREW #11, THEN ROTATE CW THE CUP-BALL ADJUSTMENT UNTIL IT IS TIGHT. ONCE TIGHT, LOOSEN UP THE CUP-BALL (6-026) OF APPROXIMATELY 1/16 OF A TURN CCW TO GIVE A SMALL LOOSE TO THE BALL-SCREW
2	LOOSEN BOLT #7 TO ADJUST SHUT HEIGHT. MAKE SURE TO ALWAYS RETIGHTEN BOLT AFTER ADJUSTMENT

ITEM NO.	PartNo	DESCRIPTION	QTY.
1	6-136	6T PITMAN BUSHING	1
2	6-403AS	DIGITAL SHUT HEIGHT INDICATOR ASSEMBLY (OPTIONAL)	1
3	6-029	6T PITMAN	1
4	6-028	6T CLAMP BLOCK, PITMAN	1
5		HEX NUT 7/16-14	2
6	6-090	6T RAM CLAMP STUD	2
7		HEX BOLT 7/16-14X1-1/4 LG.	1
8	6-023	6T RAM	1
9	6-027	6T BALL SCREW	1
10	6-026	6T CUP BALL ADJUSTMENT	1
11		SET SCREW 1/4-28X1/2 LG.	2
12	6-025	6T BALL SEAT	1
13	6-024	6T CLAMP BLOCK, RAM	1

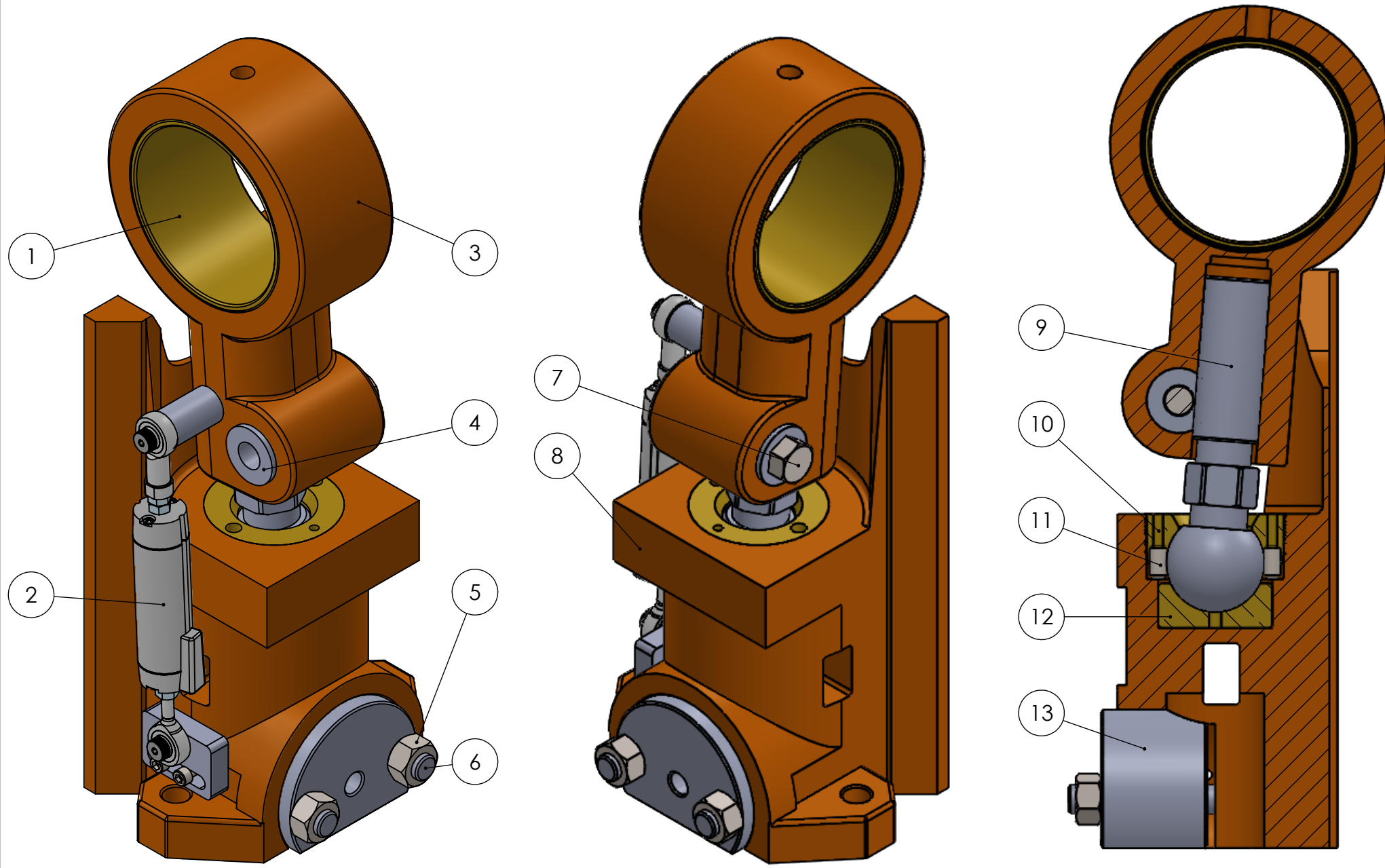

SECTION VIEW



Azimuth Machinery Ltd  
 T 450 632 8080  
 F 450 632 8081  
 www.azimuthpress.com  
 6040 Rte. 132, Ste Catherine  
 QC, Canada, J5C 1B6

DESCRIPTION  
6T RAM ASSEMBLY

CUSTOMER

DRAWN BY AZIMUTH MACHINERY	DATE 2018-05-24
ISSUED FOR	DWG. # 6-023AS

COMMENTS :

**PROPRIETARY AND CONFIDENTIAL**  
 THE INFORMATION CONTAINED IN THIS DRAWING IS THE SOLE PROPERTY OF AZIMUTH MACHINERY. ANY REPRODUCTION IN PART OR AS A WHOLE WITHOUT THE WRITTEN PERMISSION OF AZIMUTH MACHINERY IS PROHIBITED.

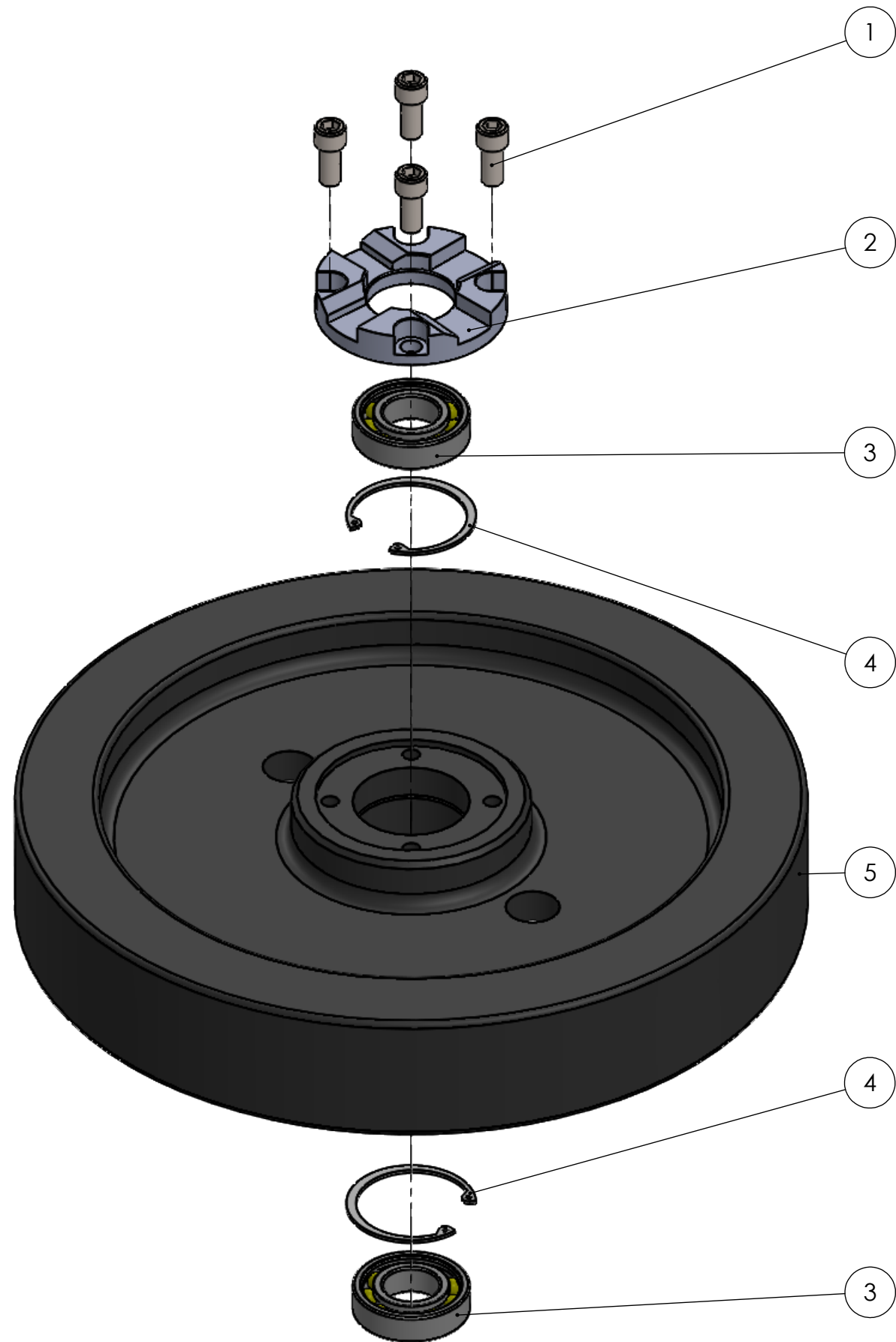

ITEM NO.	PartNo	DESCRIPTION	QTY.
1	6-085	SOCKET HEAD 7/16-14X1 LG.	4
2	6-038	CLUTCH PLATE	1
3	6-122	6T FLYWHEEL BEARING	2
4	6-109	6T FLYWHEEL RETAINING RING	2
5	6-041	6T FLYWHEEL	1

FOR DIFFERENT SIZE PRESSES, CHANGE THE FIRST DIGIT  
 EX : 6-041 IS A 6T FLYWHEEL  
 10-041 IS A 10T FLYWHEEL

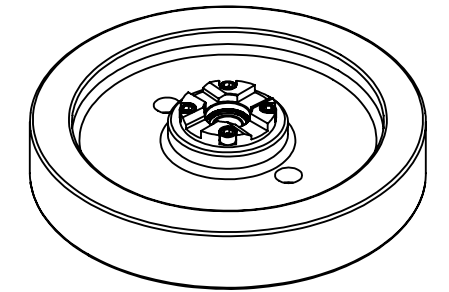

Azimuth Machinery Ltd  
 T 450 632 8080  
 F 450 632 8081  
 www.azimuthpress.com  
 6040 Rte. 132, Ste Catherine  
 QC, Canada, J5C 1B6

DESCRIPTION  
 6T FLYWHEEL ASSEMBLY

CUSTOMER

DRAWN BY AZIMUTH MACHINERY	DATE 2018-04-24
ISSUED FOR	DWG. # 6-041AS

COMMENTS :

**PROPRIETARY AND CONFIDENTIAL**

THE INFORMATION CONTAINED IN THIS DRAWING IS THE  
 SOLE PROPERTY OF AZIMUTH MACHINERY. ANY  
 REPRODUCTION IN PART OR AS A WHOLE WITHOUT THE  
 WRITTEN PERMISSION OF AZIMUTH MACHINERY  
 IS PROHIBITED.

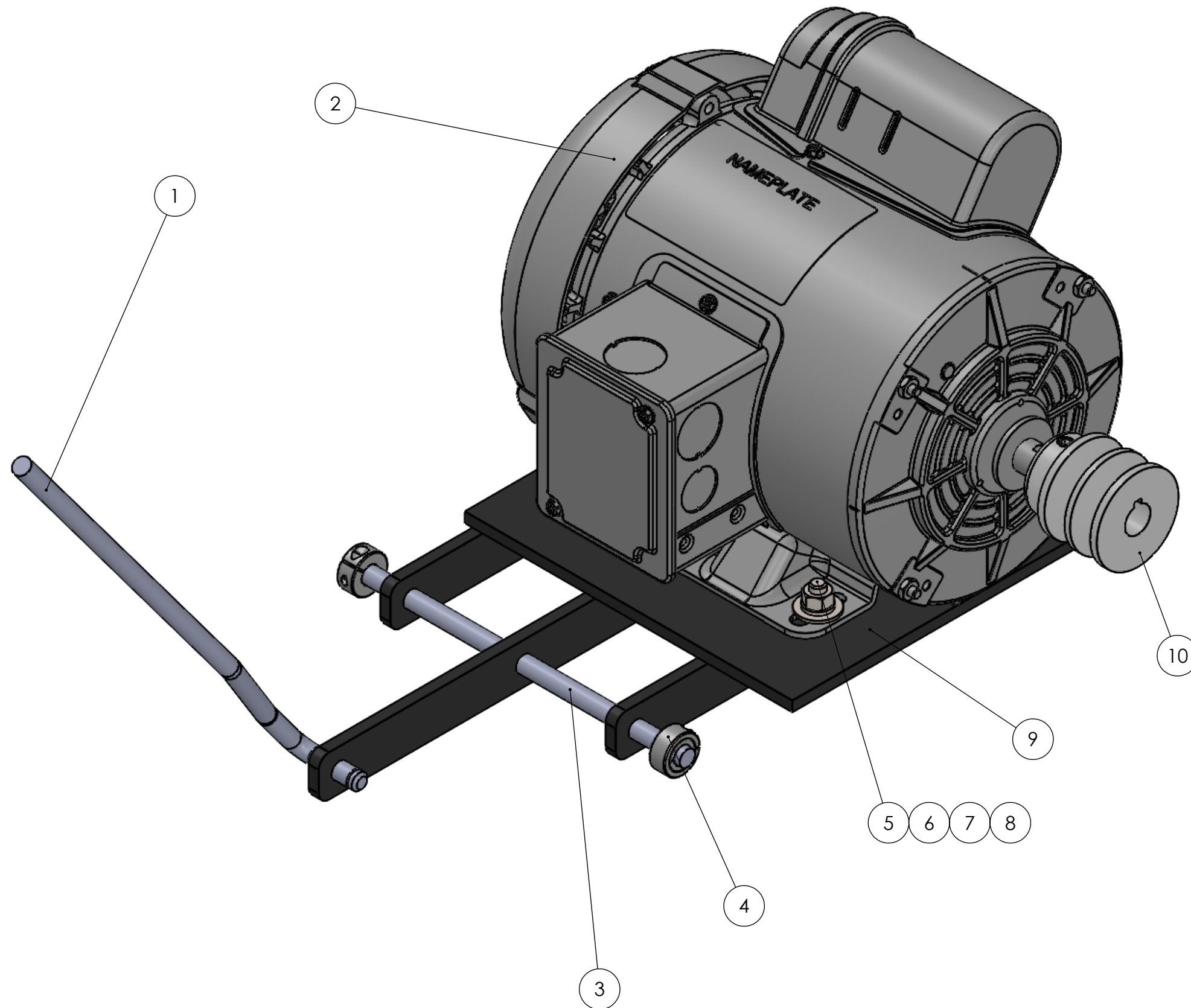

ITEM NO.	PartNo	DESCRIPTION	6-IP/QTY.
1	6-071	6T STD MOTOR BRACKET STUD	1
2	6-126	6T ELECTRIC MOTOR	1
3		STEEL ROD 3/8X7-1/4 LG.	1
4		3/8 SHAFT COLLAR	2
5		HEX BOLT 5/16-18X1 LG.	4
6		HEX NUT 5/16-18	4
7		5/16 SPRING LOCK WASHER	4
8		5/16 FLAT WASHER	8
9	6-069	6T MOTOR BRACKET	1
10	6-123	6T MOTOR SHEAVE	1



Azimuth Machinery Ltd  
T 450 632 8080  
F 450 632 8081  
www.azimuthpress.com  
6040 Rte. 132, Ste Catherine  
QC, Canada, J5C 1B6

DESCRIPTION  
6 TONS PRESS ELECTRIC MOTOR ASSEMBLY  
CUSTOMER

DRAWN BY AZIMUTH MACHINERY	DATE 2018-04-04
ISSUED FOR	DWG. #

COMMENTS :

**PROPRIETARY AND CONFIDENTIAL**

THE INFORMATION CONTAINED IN THIS DRAWING IS THE SOLE PROPERTY OF AZIMUTH MACHINERY. ANY REPRODUCTION IN PART OR AS A WHOLE WITHOUT THE WRITTEN PERMISSION OF AZIMUTH MACHINERY IS PROHIBITED.